

SHIMANO

DENDOUMARU

1000 *PLAYS*

4000 *PLAYS*

INSTRUCTION MANUAL

Thank you for purchasing a Shimano DENDOUMARU 1000 PLAYS / 4000 PLAYS.
Before using this reel, please make sure you read the manual thoroughly and keep it in a safe place for future reference.



| | | | |
|---|----|--|----|
| Safety Precautions..... | 2 | A-RB (Antirust Bearings)..... | 35 |
| Features | 8 | Automatic Gunwale Stop | 36 |
| Digital Display Component Names | 10 | Alarm (Gunwale)..... | 37 |
| Part Names..... | 11 | Programming Target Depth and Bottom Depth..... | 38 |
| Menu Button Operation | 12 | Finding the Target Depth..... | 40 |
| Power Supply Cord | 14 | Top-Down Mode Example | 41 |
| Learning Methods | 16 | Bottom-Up Mode Example..... | 42 |
| Learning Methods (Flow Diagram) | 18 | Winding In: Rakuraku Mode Fixed Speed Mode | 43 |
| Learning Methods 1. PE Line (Line with markings every meter.) | 20 | Jigging Mode | 45 |
| Learning Methods 2. Nylon Line (Line with no markers.)..... | 22 | Handling Instructions..... | 47 |
| Learning Methods 3. Backing Line..... | 24 | Specifications | 50 |
| What to do after completing Learning | 28 | Troubleshooting | 52 |
| Various Techniques..... | 30 | Product Inquiries /After Sales Service Information | 54 |
| Zero Setting | 32 | Service network..... | 55 |
| Adjusting Smart Line Depth | 34 | | |

Safety Precautions

Please read these safety precautions before using the reel.

Warning



Caution: **High Temperature**

- Use only the specified voltage (DC12~14.8V) from a battery or the vessel's onboard power supply.
Using voltages other than those specified may cause the reel to heat up, damage electrical components or burn your hand.
- NEVER connect the reel to a household power supply or a battery charger.
Doing so may damage the circuit boards and cause fire and smoke.
- Stop using the reel IMMEDIATELY if the power supply connector or alligator clips become abnormally hot.

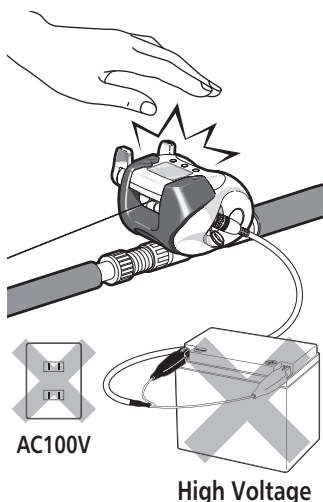

Warning



Warning

- If the circuit breaker in the reel is tripped repeatedly, it is possible that the specifications of the reel are not appropriate for the load from that particular species of fish or rig.
If you continue to use the reel in such a situation, the motor or display may overheat and be damaged. Should that occur, please change to a higher specification reel.



Warning

- If the battery mark (**B** or **⏻**) lights up and starts flashing, this means that battery voltage is dropping, which will lead to a decrease in performance. It also means that excessive load is being placed on the motor and display, which may cause the reel to malfunction. Stop using the reel immediately and connect to a fully charged battery.



Warning

- Please do NOT use the reel with a vessel's power supply or a battery that does not provide the proper voltage.
When the battery mark (**B** or **⏻**) lights up and starts flashing, winding in under heavy load (high current) may damage the electronic components in the display and cause the lens to pop out.

Warning



Don't get your finger caught!

- Do NOT put your finger near the level winding position when fishing as it may get caught and cause injury. If your finger does become caught, turn off the power switch on the reel immediately and disassemble the reel.
- Do NOT put your finger in between the handle and the body as it may get caught and cause injury.

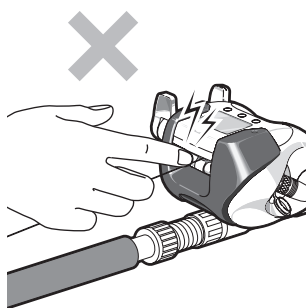

- A very weak electrical signal is produced when using the reel. This may cause medical equipment such as hearing aids and pacemakers to malfunction, causing the user to have palpitations or become dizzy.



Warning

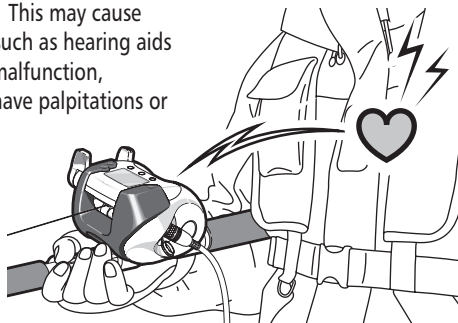

Warning



Warning

- Immediately remove the power cable if you see moisture or water droplets on the inside of the display. If you continue to use the reel in such a situation it may malfunction, break the tip of the rod and cause injury.
- Stop using the reel if you see a crack develop in the display or the case. If water penetrates into the case it can cause shorting to occur, which can damage the electronics and make it impossible to control the motor.

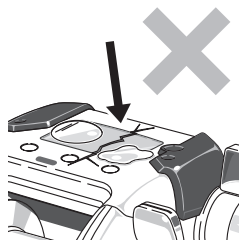

Warning

- Stop using the reel IMMEDIATELY if a burning smell or smoke is emitted from the reel or the display, or if the reel becomes abnormally hot. If you continue to use the reel in this situation then the reel may catch fire.
- Disconnect the power connector or the alligator clips from the battery immediately if the motor cannot be stopped.

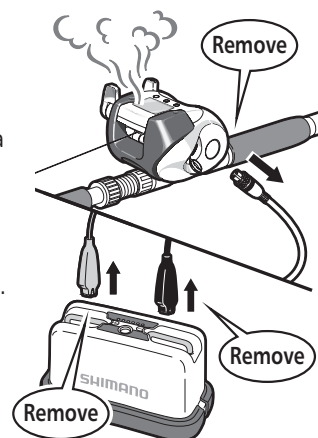

Caution



Caution

- When using the reel, if the display goes off, do not wind the line in manually using the handle as this will mean there will be a difference between the actual line length and the counter. If you do wind the line in manually using the handle, after the display comes back on and you start winding the line in again using the motor the gunwale stop position will be incorrect, which can cause the rig to be wound in too much and even snap off the end of the rod. Therefore, it is important to investigate why the display has gone off and fix the problem and to only wind in the line after the display comes back on.

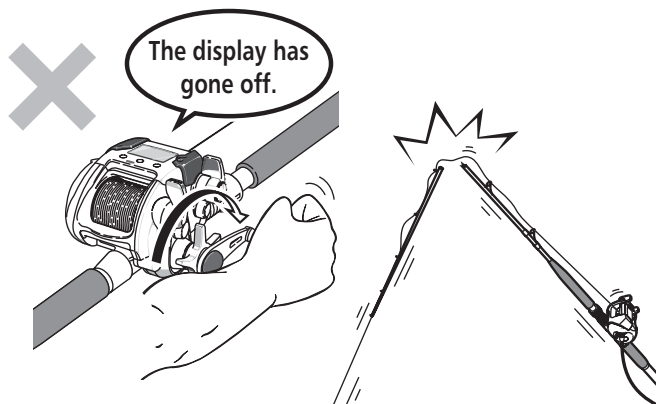

Caution



Caution

- If the surface of the coating on the reel comes off or if the surface of the material comes off due to a strong impact leaving a sharp edge, do NOT touch that area as it may cause injury.



Do not get your fingers caught!

- Do NOT touch the line when it is being fed out or wound in as the line can cut or even cut off your finger.

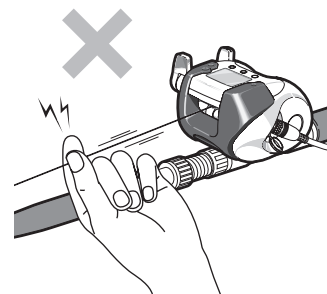

Caution: Rotating Objects

- Do NOT touch the rotating spool as this can cause injury.

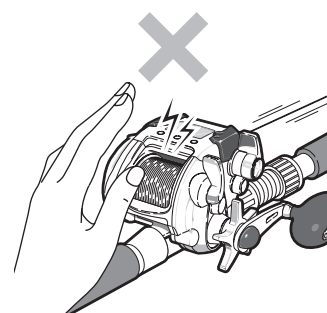



Caution



Caution: Rotating Objects

- Do NOT put your finger near rotating parts such as the spool as this can cut or even cut off your finger.

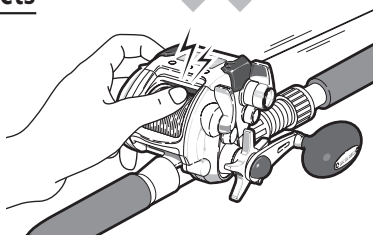

Caution

- Please secure the reel securely to the rod. Do NOT use the reel if it is cross-threaded or not properly secured as it may come off during fishing and cause injury.

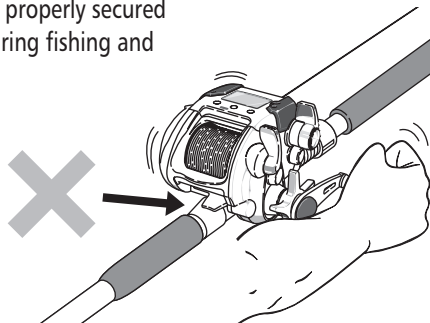

Caution



Caution

- Please store and use the reel out of the reach of children.

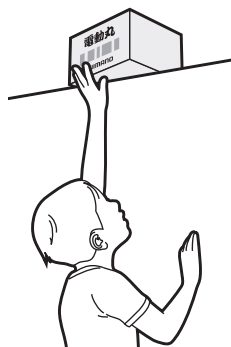

Caution

- The reel may malfunction if it is dropped and the display damaged due to the impact. Please take care to avoid any such impacts.

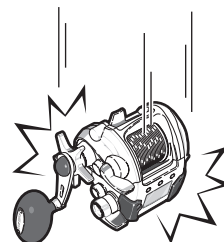

Caution

- Do NOT wrap the cable around your body as depending on how the fish is pulled in it may cause you to be thrown into the sea.

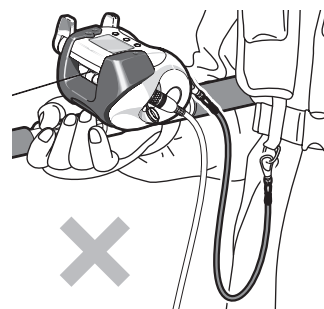



Caution



Caution

- ALWAYS remove the cable from the battery when carrying out maintenance on the reel when it is in use as the spool may move at any time causing injury to the user or damage to the reel.

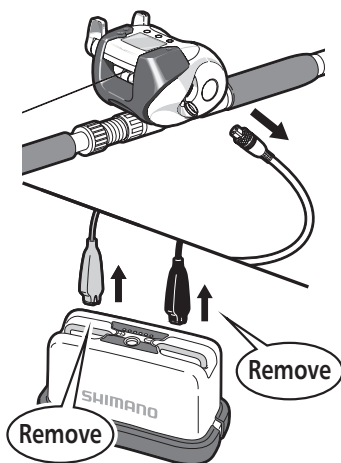

Caution

- Always decrease drag before connecting the power supply. There is the possibility that the rod may be damaged if the motor malfunctions, cannot be stopped and retrieves the rig.

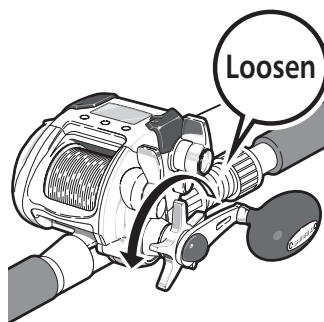

Caution



Do NOT Disassemble

- Please do not modify the reel as this can cause performance to deteriorate and safety features to malfunction.
- Please do not modify the cable as this may cause performance to deteriorate, generate heat or result in a fire.

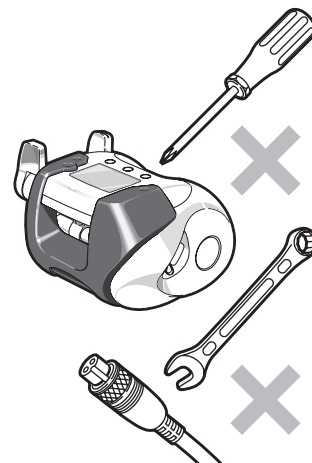

Caution

- The gunwale stop position may change according to factors such as retrieval tension. If the gunwale stop position changes, please reset the counter to zero again. This is just in case the gunwale stop position changes, which can break the tip of the rod.

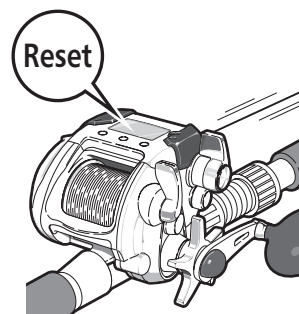



Caution



Caution

- Please do NOT touch the metal parts of the alligator clips or the terminals of the battery or power supply with wet hands as there is the danger of electric shock.



Caution

- Check that the terminals are not wet before attaching the power cord to the reel. If the terminals are wet this can cause a short circuit, which may result in fire or smoke that can lead to injury.

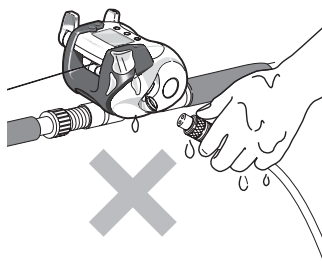

Caution

- If your rig is caught on the bottom, wind the line around a rod holder or the gunwale and cut it rather than trying to jerk it free.



Caution



Caution

- Do NOT try to dry the reel using a hair dryer or some other heating appliance after carrying out maintenance as this may deform the resin.

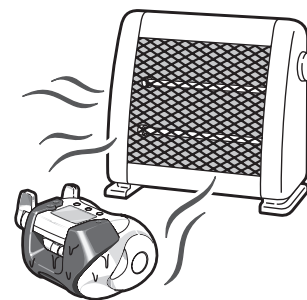

Caution: Motor Malfunction

- The display is water-resistant to a depth of 10m. However, if the reel is dropped or receives an impact of some kind and the display is damaged or cracked, the motor may malfunction if water is able to penetrate into the reel. As injury may occur if the motor malfunctions and suddenly retrieves the line, etc., if the display is cracked or damaged, immediately remove the power cord, stop using the reel and return it to the place of purchase. If there is no licensed Shimano dealer nearby, please enquire as to the location of your nearest service center.
- This reel operates on DC12~14.8V. Using a higher voltage or a household power supply may damage the electronic circuits in the display and make it impossible to control the motor. As this could also result in smoke or fire, always check the specification of the power supply before use.

Features



Bringing you an even smoother spool.

Antirust Bearings Page 35

A highly corrosion-resistant metal is densely packed onto the bearing's surface, using a process known as surface reforming. This creates a stable, immovable layer that ensures total protection. Anti-Rust Bearings in both ends of the spool make for an even smoother performance!



Select between two modes when reeling in your fish.

You can select between Rakuraku Mode and Fixed Speed Mode Pages 43~44

Select between Rakuraku Mode, which maintains a specific line tension, and Fixed Speed Mode, which maintains a fixed spool rotation speed, according to your situation.



Lightweight, compact design that is among the best in its class.



Switch between high speed and high power.



Consistently position your rig more accurately at the desired depth.

Zero reset. Pages 32~33

The counter can be reset to zero with the rig touching the surface of the water. This allows you to more accurately position the rig at the desired depth.



Stops retrieving the line at the point where you can raise the rod vertical and have the rig come straight to your hand. Pages 36~37

The gunwale stop position is set automatically, allowing you to raise the rod vertical and have the rig come straight to your hand.



Allows you to easily return your rig to the same depth after repairing your line if it breaks. Page 34

If you break your line, after repairing it, lower the rig to the surface and press 0 Set. The Smart Line Depth function then automatically returns your rig to the same depth it was at before it broke.



The Technical Lever

is used to adjust retrieval speed and Rakuraku settings.  Pages 11, 43~44



The new SLSII system requires no programming. SLSII (Shimano Line Program System 2)

 Pages 16~27



An alarm sounds at a predetermined depth.

 Pages 38~39

Set the shelf or bottom depth and next time you let down your rig an alarm will sound when that depth is reached.



Select between

Surface-Down and Bottom-Up Modes for the display. Pages 40~42

Depth can be shown as distance from the surface or distance from the bottom to best suit factors such as fishing ground, fishing technique and target species.



Let down your line faster with

the Auto Casting function. Page 31



The reel replicates the jigging technique.

Jigging Mode Pages 45~46

Jigging mode is a new function that enables the reel to replicate the popular jigging technique.

* In some cases 0 Set cannot be changed in Jigging Mode. Please turn Jigging Mode OFF before pressing the 0 Set | Enter Button.

The following icons appear in the manual and have the following meanings:

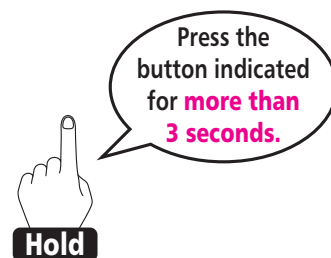
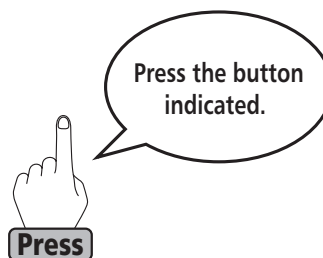

Caution:

The values and settings shown on the reel display in this manual are in some cases just examples. Actual values may differ.

Digital Display Component Names

Bottom-Up Mode (Icon: 底)

In Bottom-Up Mode ▶ will be displayed to the left of the Bottom-Up icon.

If ▶ is not displayed then the reel is in Top-Down Mode.

Present Depth

Displays depth from the surface of the water.
(In Bottom-Up mode it displays the distance from the bottom.)

* Depth is shown in 10cm graduations. Depths over 100m are shown in 1m graduations as shown on the right.

99.9 → 100

Technical Lever Settings

Displays Rakuraku mode and Fixed Speed Mode values.

Menu | Rakuraku/Fixed Speed Button



Press Menu to toggle through the menu items. The icon for the appropriate item (底 bottom-up, 糸送 casting, さそい jigging) will flash. Press Menu again to return to Standard Mode. Used together with the Enter button.



Press for more than 3 seconds to switch between Rakuraku Mode and Fixed Speed Mode. You can press this button even when reeling in. The mode selected will be shown on the display.
Rakuraku Mode: Green Backlight (楽 is displayed)
Fixed Speed Mode: Orange Backlight (速 is displayed)

0 Set/Enter Button



Press Enter to turn ON or OFF the function selected using the Menu button.



Zeroing the Counter
Lower the rig to the surface of the water and zero the counter.
* It may not be possible to zero the counter if Jigging Mode is ON. Always turn Jigging Mode OFF before zeroing the counter.

Auto Casting Function

When lowering the rig, the motor will start automatically 5m past the gunwale stop position and spool resistance will be reduced to a minimum. The ▶ to the left of 糸送 will not be displayed when this function is OFF. (E.g. If the gunwale stop position is set at 1m then the motor will start at 6m.)

Jigging Mode (Icon: さそい)

▶ is displayed to the left of the Jigging icon in Jigging Mode.

Saved Depth

Memo Button



Saves the present depth from the surface. In Bottom-Up mode, the counter shows the depth from the bottom as the **Present Depth**, starting from 0.0m.

Mode Indication

学習 Normal | 下巻 Backing :

These icons are displayed in Learning Mode.

棚 : Displayed in Surface-Down Mode.

底 : Displayed in Bottom-Up Mode.

オート : Displayed when the Auto Depth Function is ON.

楽 : Displayed in Rakuraku Mode.

速 : Displayed in Fixed Speed Mode.

セット : Displayed for 2 seconds when Line Learning or 0 Set is selected.

B :

Displayed when battery or power supply voltage is too low.

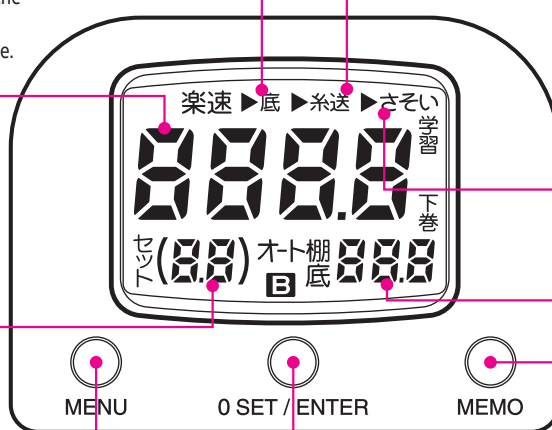

Part Names

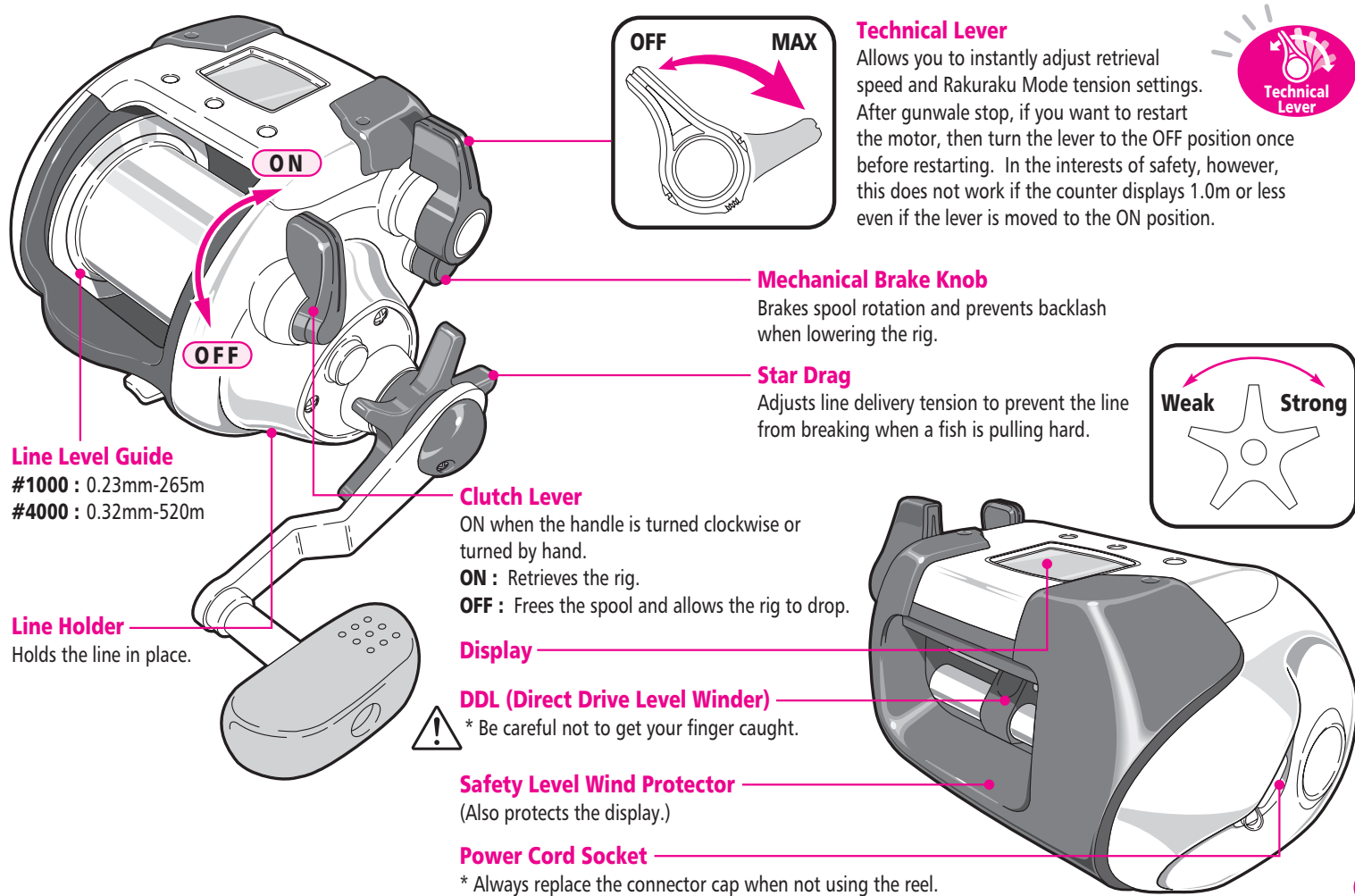

Menu Button Operation

The Menu Button is used to set the following functions:

Bottom-Up Mode ON/OFF
Auto Casting Function ON/OFF
Jigging Mode ON/OFF

- When the motor is stopped in Standard Mode, press Menu repeatedly (for less than 3 seconds) to toggle through the menu items.

The icon for the appropriate item (底 bottom-up, 糸送 casting, さそい jigging) will be displayed.

Press Menu again to return to Normal Mode.

- When the desired icon is flashing, press Enter to turn that function ON or OFF. The display will then return to Standard Mode.
- When you have changed setting in Standard Mode (Startup Screen), even if you turn the power OFF the new settings will be saved.

Icons with a flashing ► on the left are ON.

The state of the functions in the example are as follows:

Bottom-Up Mode (底)OFF
 Auto Casting Function (糸送) OFF
 Jigging Mode (さそい)OFF

Standard Mode

This is the mode used when actually fishing. When you turn the reel ON you will be in this mode.

* Startup Screen

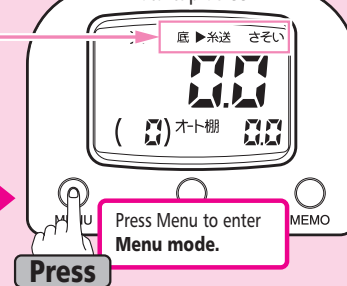

Press Menu to enter Menu mode.

Press Menu to return to Standard Mode

Menu 3: Jigging Mode



Jigging will flash.

Press Menu to go to the next Menu.

Press Menu to go to the next Menu without making any changes.

Press

Press

Press 0 Set|Enter to turn the function ON or OFF.

The example here shows how to turn Jigging Mode ON. Repeat the same procedure to turn it OFF.



This will confirm the change and return you to Standard Mode.

Menu 2: Auto Casting Function



Auto Casting will flash.

Press Menu to go to the next Menu without making any changes.

Press

Press

Press 0 Set|Enter to turn the function ON or OFF.

The example here shows how to turn the Auto Casting Function OFF. Repeat the same procedure to turn it ON.



This will confirm the change and return you to Standard Mode.

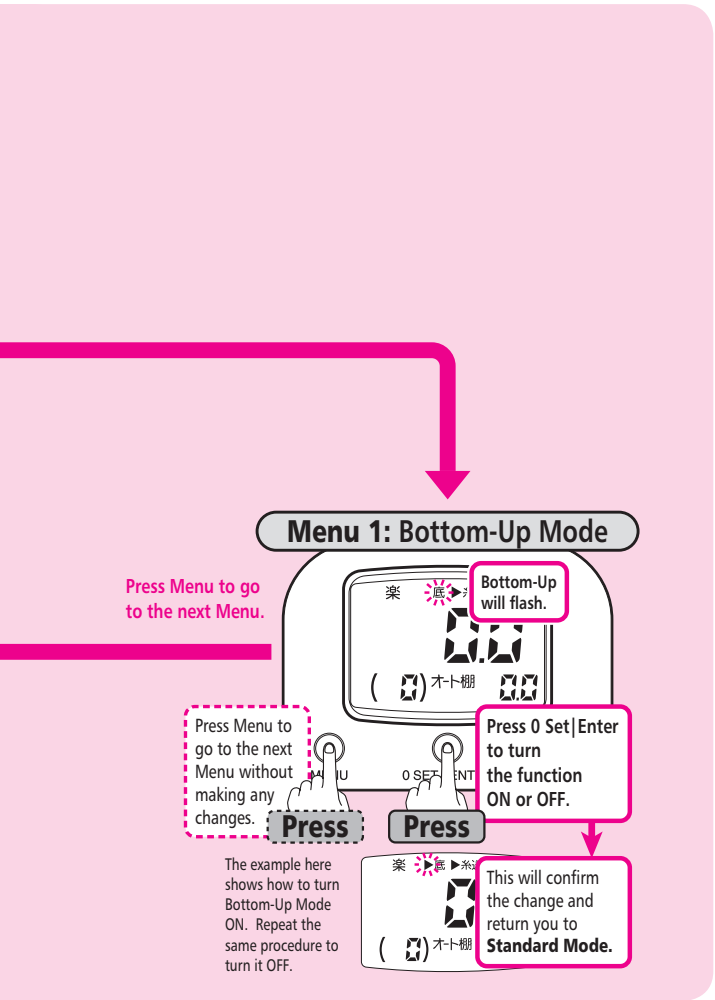

Power Supply | Cord

1 Handling Precautions

Power Supply

This reel can use 12V DC power supply with a nominal voltage of 12~14.8V (lithium-ion batteries, etc.). Do NOT use the reel with any kind of unspecified power supply (e.g. a vessel's on-board power supply or a AC100 household power supply). NEVER use a battery charger.

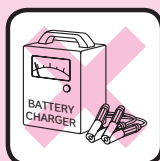
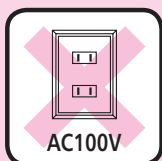
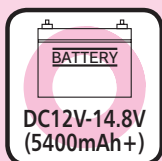

- When using a vessel's on-board power supply, always check that the voltage is DC12V. (Only use a vessel's battery if it is 12V or if you use a 24V to 12V DC-DC converter.) If the battery terminals are corroded, the voltage may not be stable, which can cause the reel to malfunction.
- Only use a fully charged battery.
- If a battery is used for a long period of time it loses charging capacity. If that occurs get a new battery.
- NEVER use an AC power supply as it will destroy the reel's electronics.
- It may not be possible to properly attach the alligator clips to the terminals of other batteries from other manufacturers and in some cases using batteries from other manufacturers may cause damage to such batteries.

Power Cord

Always use a genuine Shimano power cord to connect your reel to the power supply.

The power cord is a consumable. Depending on frequency of use, it may need to be changed every 2~3 years.

Caution

Using a power cord other than a genuine Shimano item may cause the reel to malfunction. Please do not treat the power cord in a rough manner, stand on it or fold or bend it as this can cause it to break.

2 Connecting a Battery

1 Please use the supplied power cord to connect to the battery.

Firstly connect the red connector to the positive electrode and the black connector to the negative electrode.

2 Next connect the power cord to the reel.

Line up the connections and insert the power cord into the socket in the bottom of the reel, pushing it firmly in and then tightening the lock screw.

* Please do NOT push any buttons while connecting the power cord.

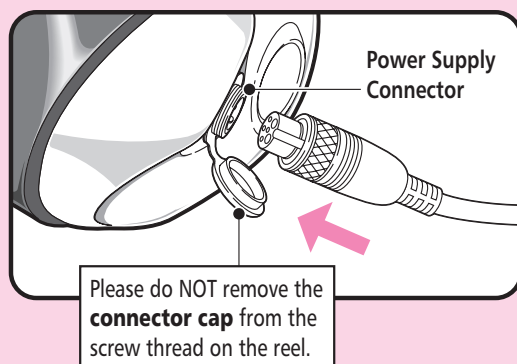

Learning Methods (Entering the actual line length into the reel.)

Spooling Up the Line

- 1** Feed the line through the level winder.
When threading the line, use the threading pin provided.

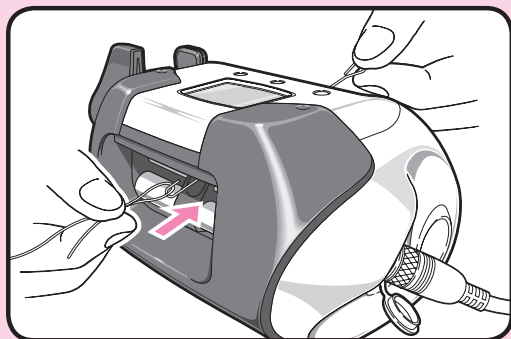

- 2** Tie the line to the spool pin.

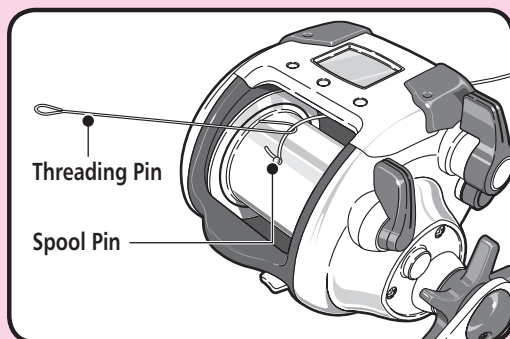

Selecting Learning Methods

Firstly, change from standard mode to learning mode as shown below. Be sure to select the learning method that best matches the type of line you will be using.

Please refer to the following page for details regarding each learning method.

- * This operation cannot be carried out unless a power supply is connected.
- * Carry out this operation when the display shows less than 6m. Please reset the counter if the value displayed is greater than 6.1m.

Caution:

If Learning is carried out when **B** is displayed then the display may go off. If it does, please start Learning again from the beginning.

Standard Mode

Used when actually fishing.
The reel is in this mode when initially turned ON



Press Enter and Memo at the same time for more than 3 seconds to enter **Learning Mode**.

Hold

* Carry out this operation when the display shows less than 6m.
Please reset the counter if the value displayed is greater than 6.1m.

Press Menu to return to Standard Mode

Learning Mode (Wind Down Learning)

Used when winding backing line.

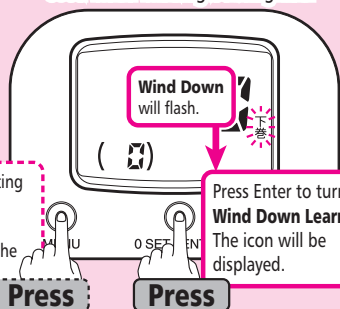

Press Enter to turn ON **Wind Down Learning**.
The icon will be displayed.

When not selecting Wind Down Learning, press Menu to go to the next menu.

Press

Press

Press Menu once to go to the next menu.

Learning Mode (Normal Learning)

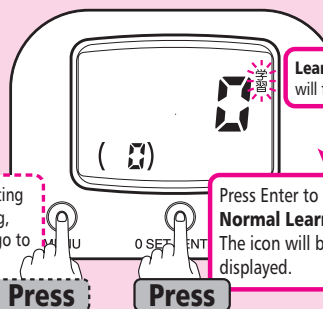

Press Enter to turn ON **Normal Learning**.
The icon will be displayed.

When not selecting Normal Learning, press Menu to go to the next menu.

Press

Press

Learning Methods (Flow Diagram)



Before winding line, please look though the following flowchart to gain an understanding of the overall process. There are 3 Learning Modes. Please see the following pages for more details.

*This operation cannot be carried out unless a power supply is connected.

When NOT using a backing line.

1 PE Line (See Pages 20~21.)

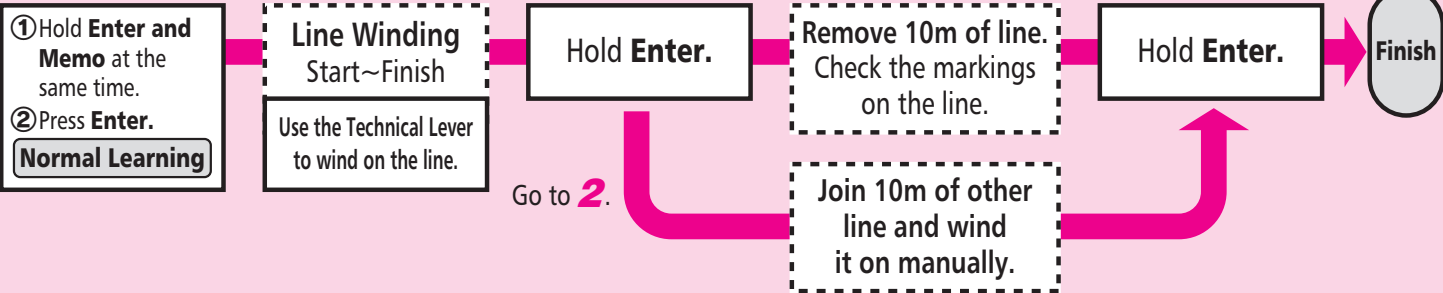

2 Line with No Markings (See Pages 22~23.)

When using backing line.

3 Use the Line Level Guide on the spool when winding on 0.23mm-265m of line (0.32mm-520m for the #4000). (See Pages 24~27)

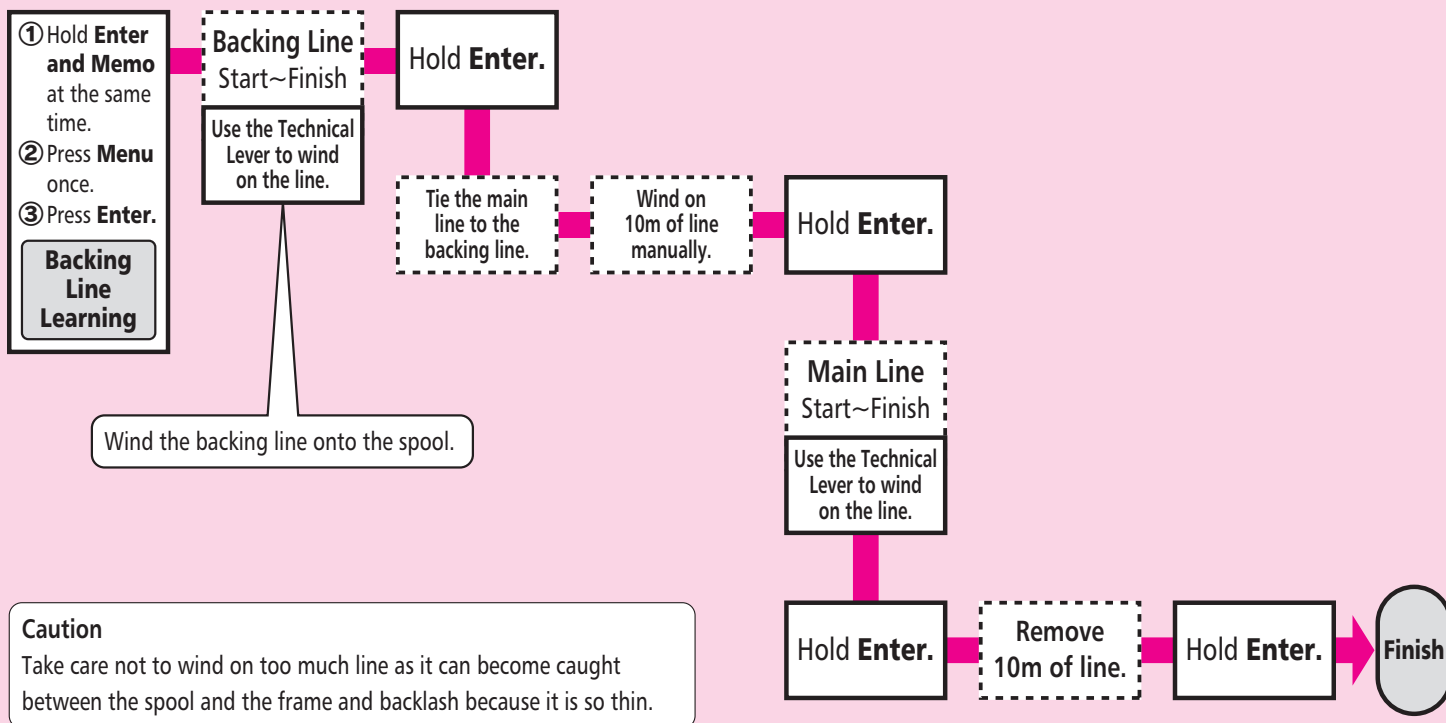

Learning Methods (Inputting the actual value of the line use into the reel.)



1 PE Line (Line with markings every meter.) → Use Normal Learning. (学習)

Please see Pages 22~23 when winding lines such as nylon (line with no markings every meter).

Learning can also be carried out using backing line. **Learning Mode (Backing Line Learning)** See Pages 24~27.

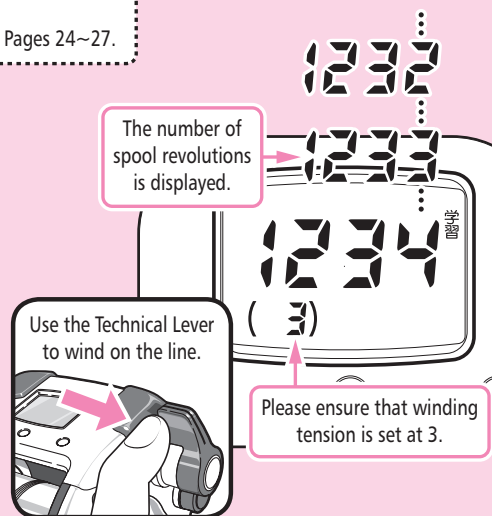
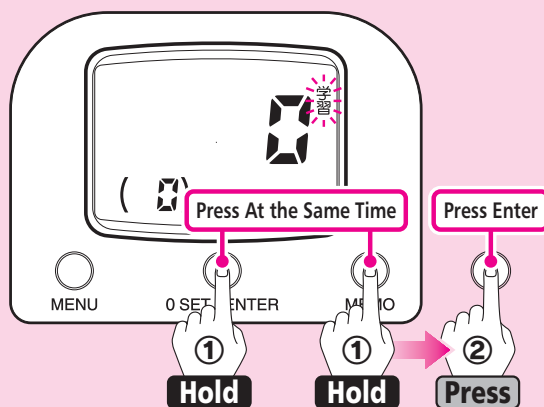
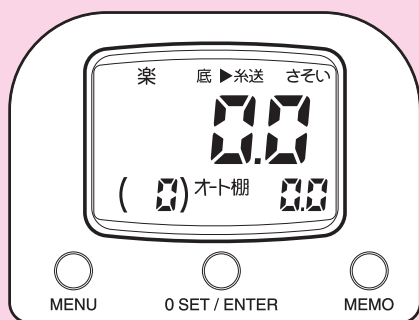

- 1 Do this when the display shows less than 6m. Reset the counter if the display shows more than 6.1m (see Pages 32~33).

Engage the clutch. Check the power supply.

The display should be as shown in the diagram. (This is Standard Mode.)

- 2 Press Enter and Memo at the same time for more than 3 seconds to enter Learning Mode.

Learning 学習 (Normal Learning) will flash.

Press Enter to select Normal Learning.

学習 (Learning) will be displayed.

(Please see Pages 16~17 Selecting Learning Methods for details regarding how to select learning methods in Learning Mode.)

- 3 Use the Technical Lever to wind on line.

The number of spool revolutions will be displayed.

Please ensure that winding tension is set at 3 in the brackets.

This value refers to line tension when winding in line. The value shown is NOT in kg and is different again from the values displayed in Rakuraku Mode.

Winding speed can be adjusted using the Technical Lever. To stop winding in, move the Technical Lever to the OFF position.

Caution: The values and settings shown on the reel display in this manual are in some cases just examples. Actual values may differ.

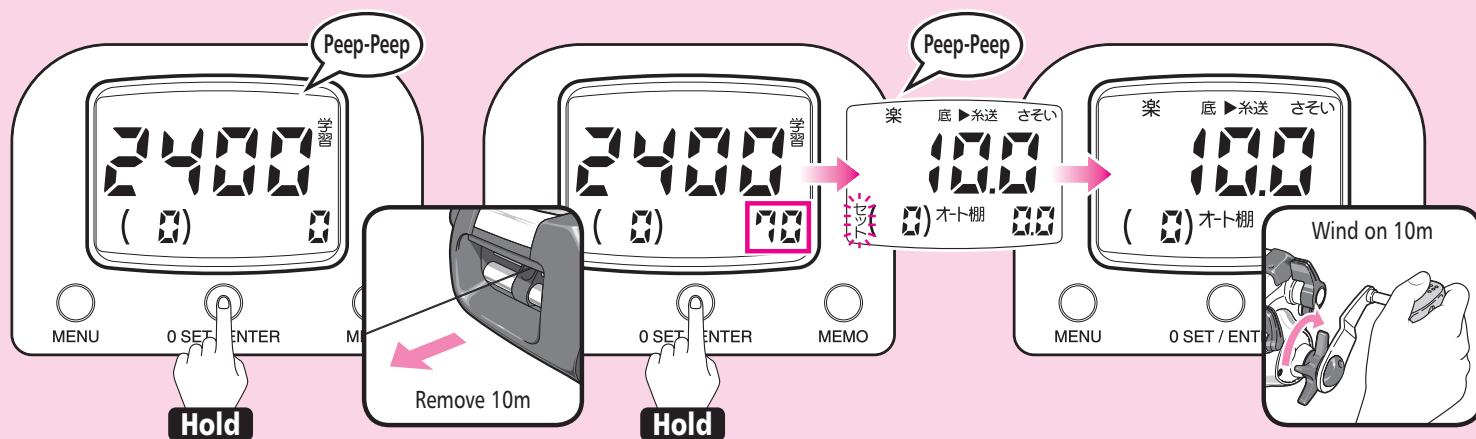

- 4** After completely finishing winding line, press Enter for more than 3 seconds. The alarm will sound (peep-peep) and the display will appear as shown in the diagram. Accurately remove 10m of line. (Check this according to the changes in line color that occur every 10m or according to the number of marks on the line that appear every meter.)

- 5** The number of spool revolutions will be displayed in the bottom right of the display (the area shown inside the square). Press Enter for more than 3 seconds to exit Learning Mode. The alarm will sound (peep-peep) and セット will be displayed for 2 seconds.
* If you accidentally press Menu while winding on line data will be lost and you will have to repeat the process once more from the beginning.

- 6** The display will return to Standard Mode and learning will be complete. (In some cases there may be as much as a $\pm 3\%$ difference between the value shown on the display and the actual length of the line.)
* The difference is the difference on the first attempt after learning has been completed.

- 7** Wind up the 10m of line that was removed.

Learning Methods (Inputting the actual value of the line use into the reel.)



2 Nylon Line (Line with no markers.) → Use Normal Learning. (学習)

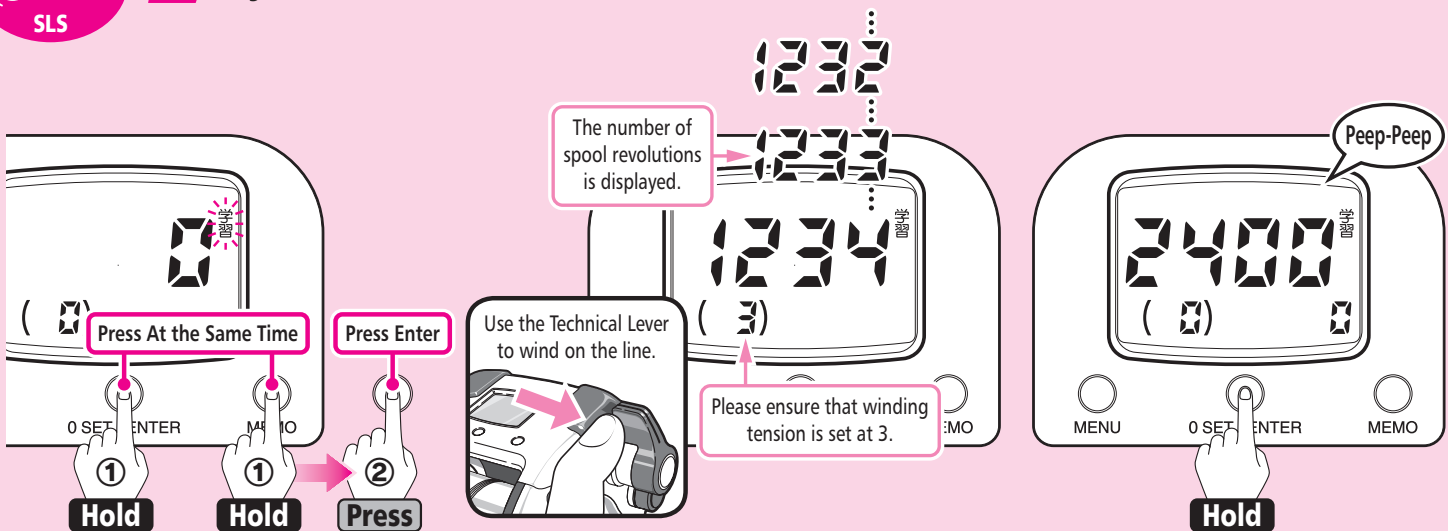

- 1 Do this when the display shows less than 6m. Reset the counter if the display shows more than 6.1m (see Pages 32~33).

Engage the clutch. Check the power supply. Press Enter and Memo at the same time for more than 3 seconds to enter Learning Mode.

Learning 学習 (Normal Learning) will flash.

Press Enter to select Normal Learning.

学習 Learning will be displayed.

(Please see Pages 16~17 Selecting Learning Methods for details regarding how to select learning methods in Learning Mode.)

- 2 Use the Technical Lever to wind on line. The number of spool revolutions will be displayed. **Please ensure that winding tension is set at 3 in the brackets.**

This value refers to line tension when winding in line. The value shown is NOT in kg and is different again from the values displayed in Rakuraku Mode.

Winding speed can be adjusted using the Technical Lever. To stop winding in, move the Technical Lever to the OFF position.

- 3 After completely finishing winding line, **press Enter for more than 3 seconds.** The alarm will sound (peep-peep) and the display will appear as shown in the diagram.

Caution: The values and settings shown on the reel display in this manual are in some cases just examples. Actual values may differ.

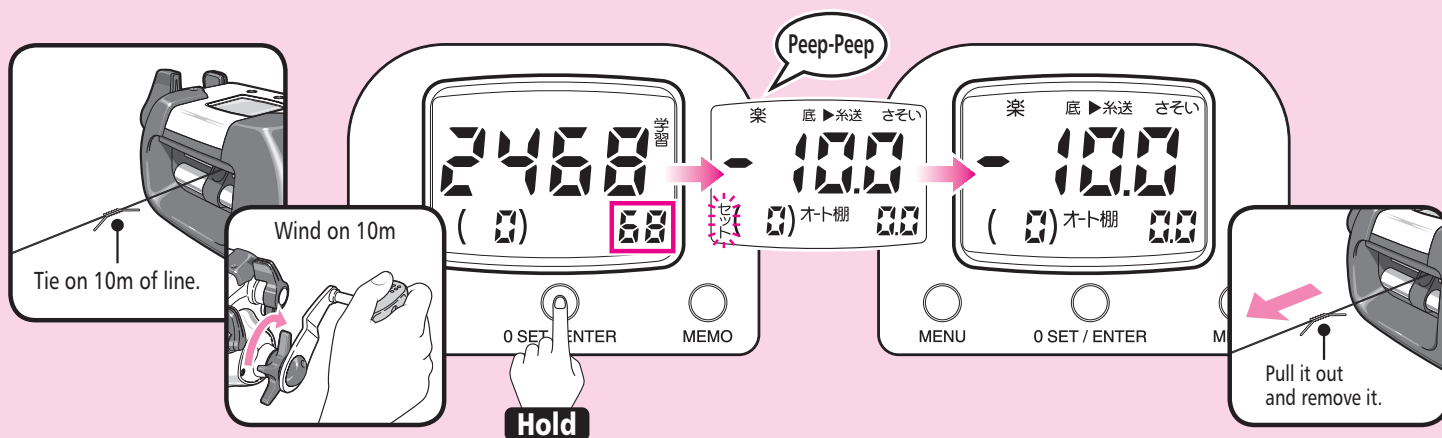

4 Tie 10m of different line to the end of the line you wound on.

5 Wind on the joined line manually.

The number of spool revolutions will be displayed in the bottom right of the display (the area shown inside the square).

Press Enter for more than 3 seconds to exit Learning Mode.

The alarm will sound (peep-peep) and セット will be displayed for 2 seconds.

* If you accidentally press Menu while winding on line data will be lost and you will have to repeat the process from the beginning.

6 The display will return to Standard Mode and learning will be complete.

(In some cases there may be as much as a $\pm 3\%$ difference between the value shown on the display and the actual length of the line.)

* The difference is the difference on the first attempt after learning has been completed.

7 Pull out the joined line and remove it.

Caution

In some cases a difference of more than 3% occurs with nylon line because the tension changes with repeated winding in. Please take care to watch for tangles at the tip of the rod when using it.

Learning Methods (It is also possible to use Learning for backing line.)



3 Please use the Line Level Guide and Backing Line Learning (下巻) when winding on 0.23mm-265m of line (0.32mm-520m for the #4000).

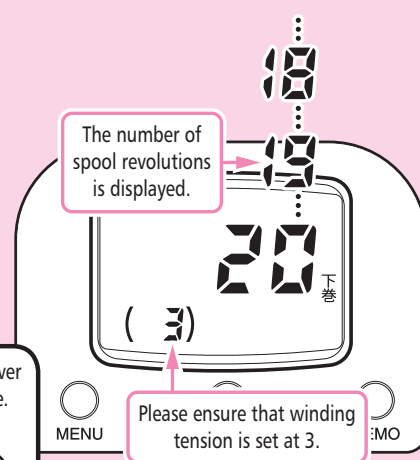
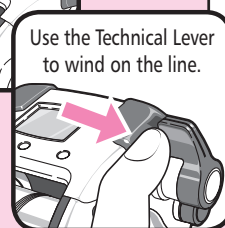
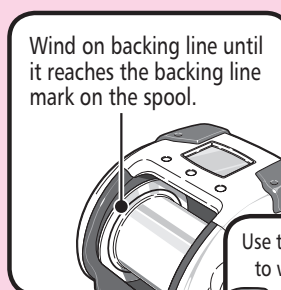
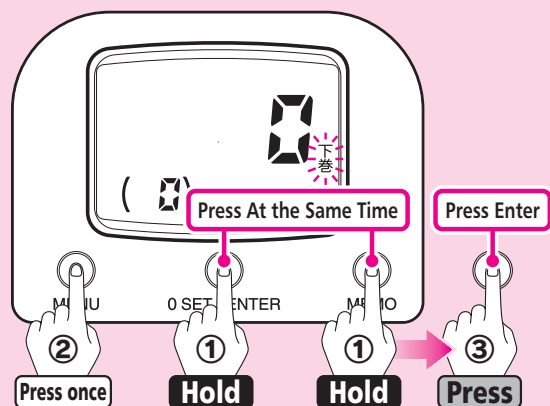

- 1 Do this when the display shows less than 6m.
Reset the counter if the display shows more than 6.1m (see Pages 32~33).
Press Enter and Memo at the same time for more than 3 seconds to enter Learning Mode and then press Menu once.
Backing Line Learning (下巻) will flash.
Press Enter to select Backing Line Learning.
Backing Line Learning (下巻) will be displayed.
(Please see Pages 16~17 Selecting Learning Methods for details regarding how to select learning methods in Learning Mode.)

- 2 Wind on line using the backing line mark as an estimate.
Use the Technical Lever to wind on the line.
Please ensure that winding tension is set at 3 in the brackets.
Winding speed can be adjusted using the Technical Lever.
To stop winding in, move the Technical Lever to the OFF position.

Caution: The values and settings shown on the reel display in this manual are in some cases just examples. Actual values may differ.

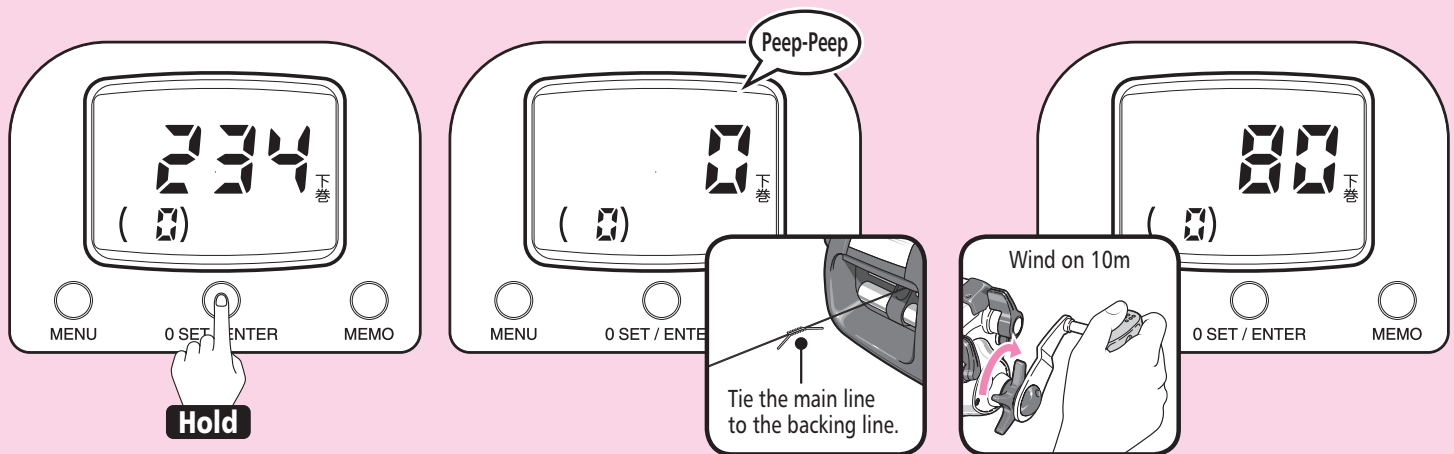

3 When backing line learning has finished, press Enter for more than 3 seconds.

4 The alarm will sound (peep-peep) and the display will appear as shown in the diagram.
Tie the main line to the backing line.

5 Accurately wind on 10m of main line.
The number of spool revolutions will be shown on the display.

(Continued on the next page.)

Caution: The values and settings shown on the reel display in this manual are in some cases just examples. Actual values may differ.

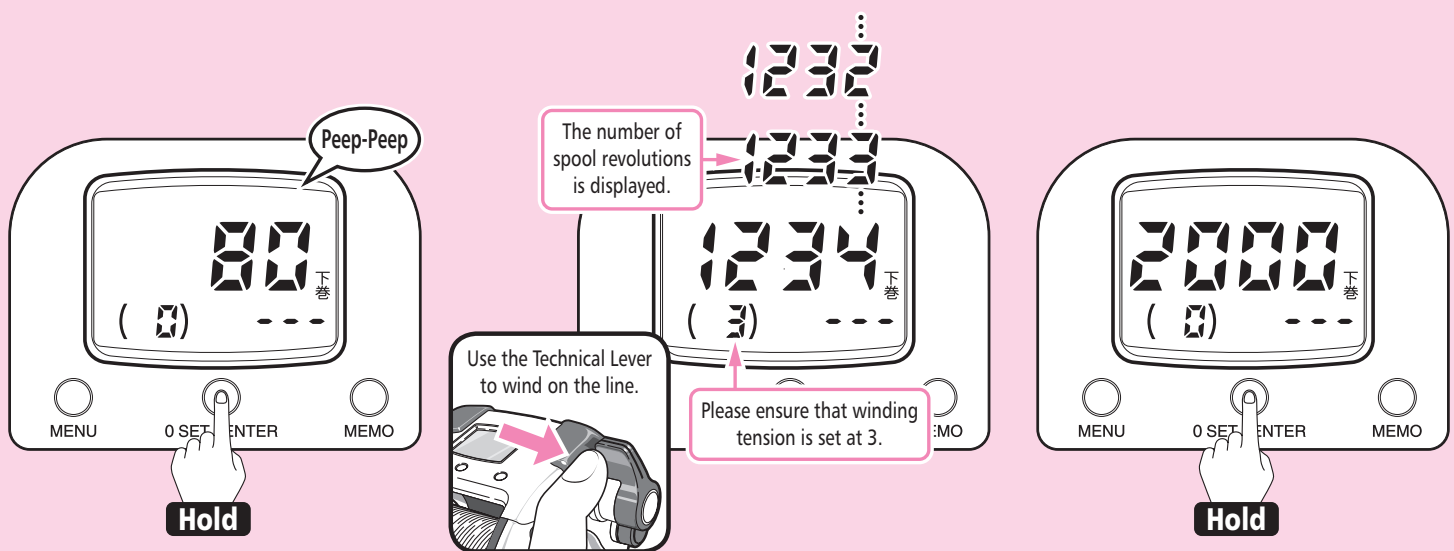

- 6** Press Enter for more than 3 seconds.
The alarm will sound (peep-peep) and the display will appear as shown in the diagram.

- 7** Wind on the remainder of the rest of the main line.
Use the Technical Lever to wind on the line.
Please ensure that winding tension is set at 3 in the brackets.
Winding speed can be adjusted using the Technical Lever. To stop winding in, move the Technical Lever to the OFF position.

- 8** After completely finishing winding line, press Enter for more than 3 seconds to exit Learning Mode.

Caution: The values and settings shown on the reel display in this manual are in some cases just examples. Actual values may differ.

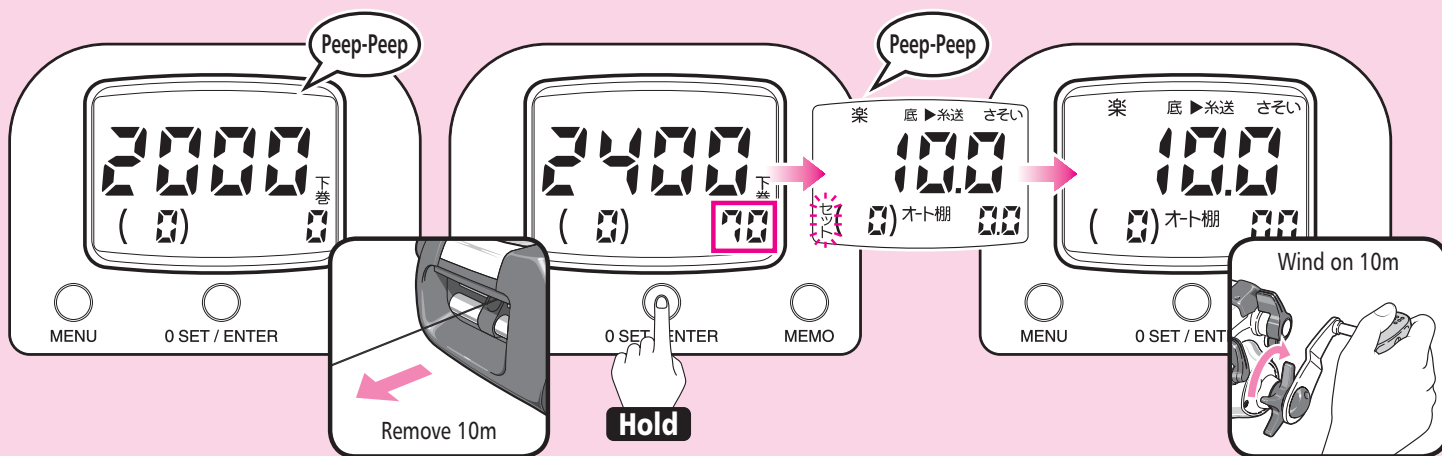

- 9** The alarm will sound (peep-peep) and the display will appear as shown in the diagram.
Accurately remove 10m of line.
 (Check this according to the changes in line color that occur every 10m or according to the number of marks on the line that appear every meter.)

- 10** The number of spool revolutions will be displayed in the bottom right of the display (the area shown inside the **square**).
Press Enter for more than 3 seconds to exit Learning Mode.

The alarm will sound (peep-peep) and セット will be displayed for 2 seconds.

* If you accidentally press Menu while winding on line data will be lost and you will have to remove the line and repeat the process once more from **1** above.

- 11** The display will return to Standard Mode and learning will be complete.
 (In some cases there may be as much as a $\pm 3\%$ difference between the value shown on the display and the actual length of the line.)
 * The difference is the difference on the first attempt after learning has been completed.

- 12** Wind up the 10m of line that was removed.

What to do after completing Learning



Basic

All you need to know in order to use the reel.



Convenient

Simple and convenient features.



Advanced

More advanced features open up a wide range of possibilities.



Zero Reset

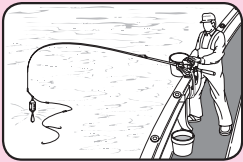

Press one button to Zero your line at the surface. Now you can accurately position your rig at your target depth.

See Pages 32~33 for details.



Gunwale Stop

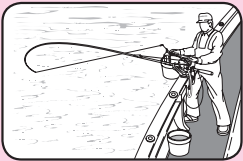

Stops retrieving the line at the point where you can raise the rod vertical and have the rig come straight to your hand.

See Pages 36~37 for details.



Technical Lever

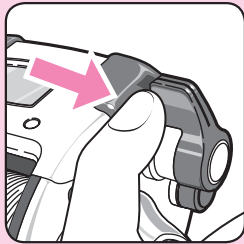

Use the Technical Lever to easily wind in your line when the bait needs to be changed or when you have hooked a fish.

See Page 11 for details.



Auto Depth Alert

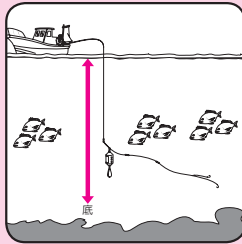

Record a specific depth and the next time you let down your rig an alarm will sound at that depth.

See Pages 38~39 for details.



Change between Top-Down and Bottom- Up modes.

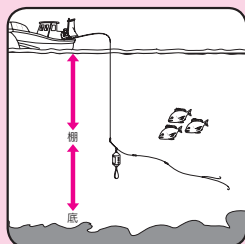

Depth can be shown as distance from the surface or distance from the bottom to best suit factors such as fishing ground, fishing technique and target species.

See Pages 40~42
for details.



Change between Rakuraku Mode and Fixed Speed Mode.

The spool rotates at
a constant speed in
Fixed Speed Mode.

Switch between
Modes

Line tension is constant in
Rakuraku Mode.

Change between Rakuraku
Mode, which maintains a
constant tension and prevent
line slack, and Fixed Speed
Mode, which maintains spool
rotation at a constant speed.

See Pages 43~44
for details.



Jigging Mode

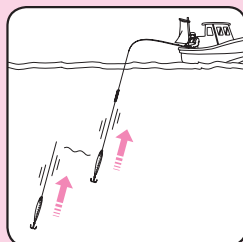

The reel replicates the popular
jigging function.

See Pages 45~46
for details.

Various Techniques (You will want to learn these techniques to improve your catch.)



Technique

Drop Your Rig Quickly

This is an especially effective technique when fishing for squid.

- Normally, the mechanical brake knob is tightened to slightly brake the free rotation of the spool to prevent backlash due to the up/down movement of the vessel.
- To drop your rig faster, use your finger rather than tightening the mechanical brake knob.

You can also use the techniques shown below.

- This reel has an Auto Casting Function. The motor automatically starts when the rig is 5m or more past the gunwale stop position and spool resistance is minimized. The motor automatically stops when the clutch is returned.

* As the motor is in operation during Auto Casting, engaging the clutch will cause the line to be slightly wound in but this is not abnormal.

- Point the tip of the rod downward to reduce guide resistance as shown in the diagram on the right.

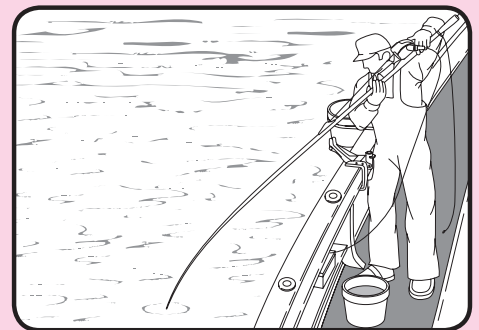
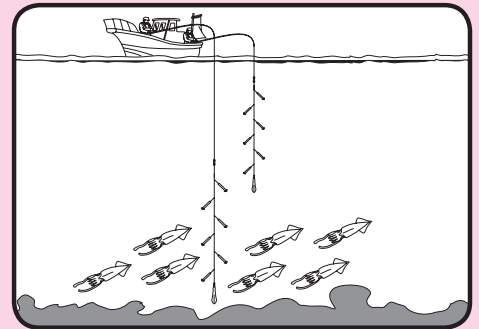

Cancelling the Auto Casting Function

When a power source is connected the Auto Casting Function will be in operation. Use the procedure shown below to turn off this function if guide resistance or backlash is a problem.

1. With the motor stopped and the reel in Standard Mode, press Menu twice.
糸送 (Auto Casting Function) will flash.
2. Press Enter to cancel the Auto Casting Function and ► will disappear.
Carry out the same procedure again when you want to restart this function.

Please see Pages 12~13 for details regarding menu button operation.

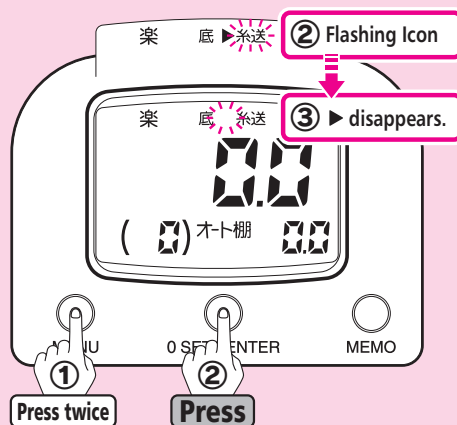

Zero Setting (Always do this before you start fishing.)

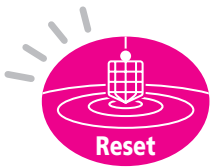

Accurately reach your target fishing depth.

If you want to improve your catch you must be able to position your rig accurately at the target depth. Zero setting resets the counter to zero when the rig is on the surface.

Zero setting enables you to know the depth of the rig and to accurately position it at the target depth.

* Do NOT wind too much line onto the spool as this can cause inaccurate readings when setting zero in one of the Learning Modes.

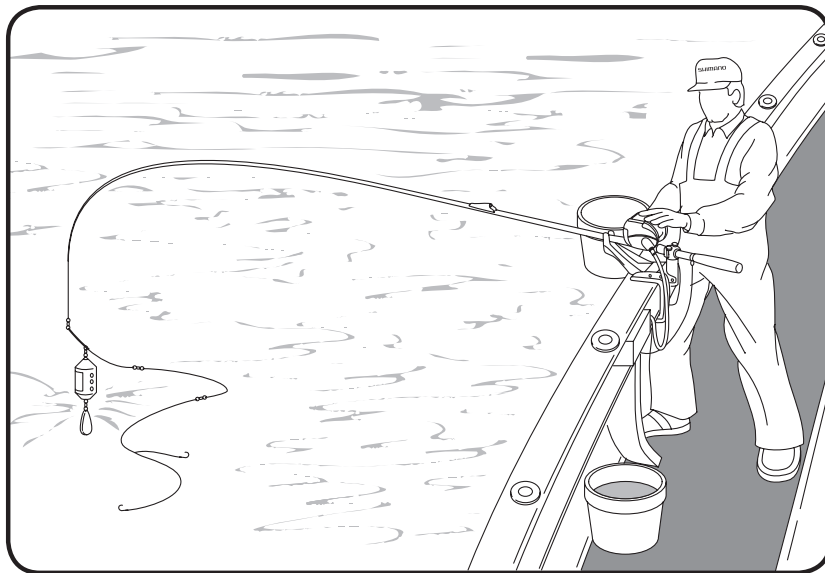

The counter can be reset to 0m when the rig is on the surface.

Let's Try Zero Setting



- 1** Lower the rig to the surface and press 0 Set for more than 3 seconds.
- 2** The alarm will sound (peep-peep) and the display will change as shown above.
- 3** Zero setting is complete.

* It may not be possible to zero the counter if Jigging Mode is ON.
Always turn Jigging Mode OFF before zeroing the counter.

Caution

Do NOT wind too much line onto the spool as this can cause inaccurate readings when setting zero in one of the Learning Modes.

Adjusting Smart Line Depth

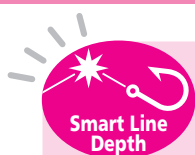

This function allows you to easily return your rig to the same depth after repairing your line if it breaks.



1 If you break your line, after repairing it, lower your rig to the surface and press 0 Set for more than 3 seconds.

2 The display will change as shown above.

3 The computer will automatically return your rig to the same depth it was at before the line broke.

Caution

Always check that Jigging Mode is turned OFF before adjusting Smart Line Depth. If it is ON and jigging starts, then the line can be wound in and cause unforeseen injuries.

Caution

Do NOT adjust Smart Line Depth with an excessive amount of line wound onto the spool as this can cause inaccurate line learning.

A-RB (Antirust Bearings)



Bringing you even smoother spool movement.

A corrosion-resistant metal is densely packed onto the surface of both ends of the spool using surface reforming technique. This creates a stable immovable layer that ensures constant protection.

Due to highly rust-resistant bearings (A-RB) inside the unit, lowering the hook has become even easier. That's why even simple float fishing, said to be troublesome with an electronic reel, can be conquered.

We have also achieved the ideal balance between the safety bar and the level wind, to completely avoid notorious and unwanted line tangles at this crucial point.

2 Antirust Bearings

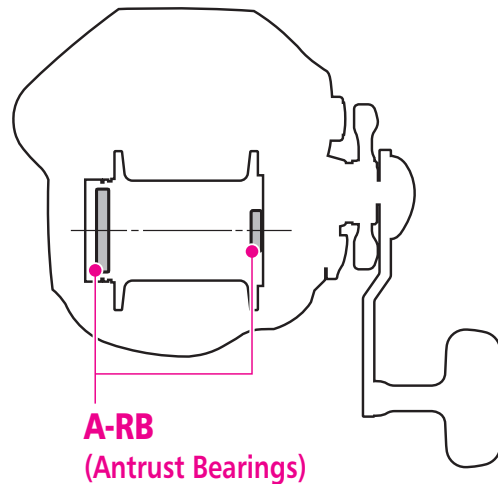

Automatic Gunwale Stop



When the motor stops, just raise your rod vertical and the rig will come straight to your hand.

You can set the reel so that when the motor stops retrieving the line you just need to raise your rod vertical to have the rig come straight to your hand.

* When connecting to a power source for the first time the Gunwale Stop is set at 6m. From the second time onwards, the position at which the reel is stopped for more than 5 seconds will automatically be remembered by the computer as the Gunwale Stop position. (This feature works within the 1m~6m range. When the depth displayed is less than 1m, in the interests of safety it is set at 1m.)

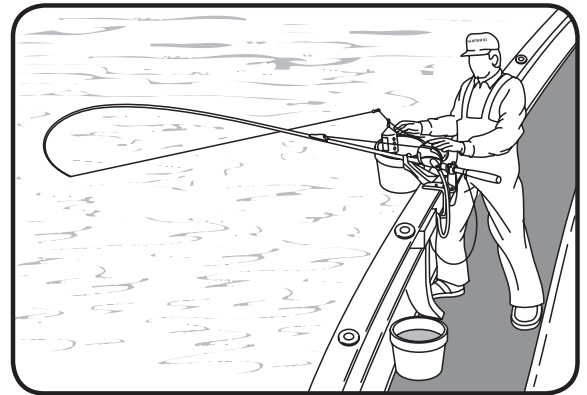

Helpful Advice

When fishing with a short rod from the bow of a boat, if zero setting is carried out in the normal way, then the Gunwale Stop Position will be outside of the normal 1~6m range.

In such cases, wind the rig up to the end of the rod and reset zero at that point to ensure that when the motor stops the rig will come to your hand when you raise the rod vertical.

In this particular situation, as zero setting is not carried out on the surface of the water, the actual distance from the end of the rod to the surface of the water will be different.

Alarm (Gunwale)

The alarm will sound 4m before the Gunwale Stop Position.

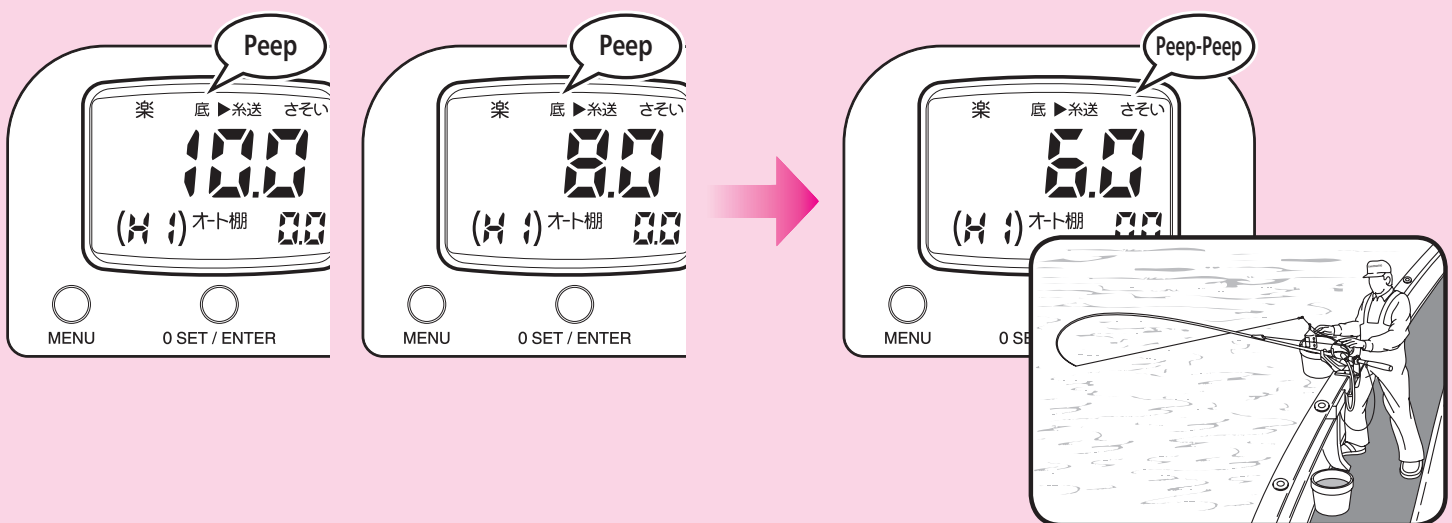

- 1** 4m before the Gunwale Stop Position the alarm will sound every 2m.
The diagram above shows the display when winding in using the Technical Lever in HI.

- 2** At the Gunwale Stop Position (in this case at 6.0m) the alarm will sound (peep-peep) and the motor will automatically stop.
After the motor has stopped you can raise the rod vertical and have the rig come straight to your hand as shown in the diagram above.

Programming Target Depth and Bottom Depth



The Auto Depth Alert can be programmed automatically or manually.

Auto

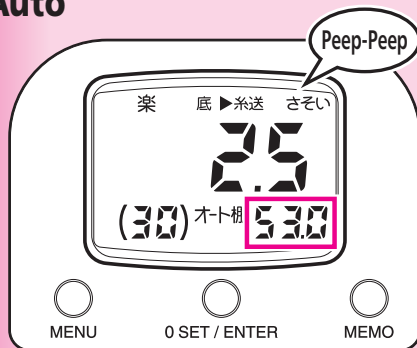

Any depth past 6.1m where the rig stops for more than 6 seconds is automatically saved as the target depth and is shown in the bottom right hand corner of the display when the rig is stopped at the Gunwale Stop Position (the figure shown above inside the **square**).

If the rig stops for more than 6 seconds more than once, the last depth is saved as the target depth. If the rig stops for less than 6 seconds then the maximum depth will be reached and saved in the memory.

The example shown in the diagram above is for Top-Down Mode. The figures shown on the display are for illustration purposes only.

Manual



Lower the rig to the target depth (6.1m or more) and press Memo.

オート (Auto) will disappear from the display. In the diagram above, a depth of 102m has been saved manually (the figure shown above inside the **square**).

In Bottom-Up Mode, the current depth is set to 0.0m.

The Auto Depth Alert can be set as many times as you like.

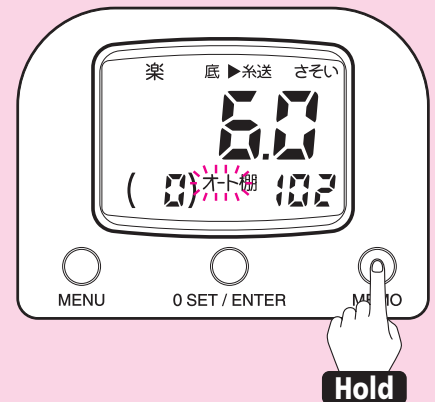

Changing from Manual to Auto

Press Memo for more than 3 seconds when the rig is at the Gunwale Stop Position to change back to auto mode.

The alarm will sound 4m before the saved depth.

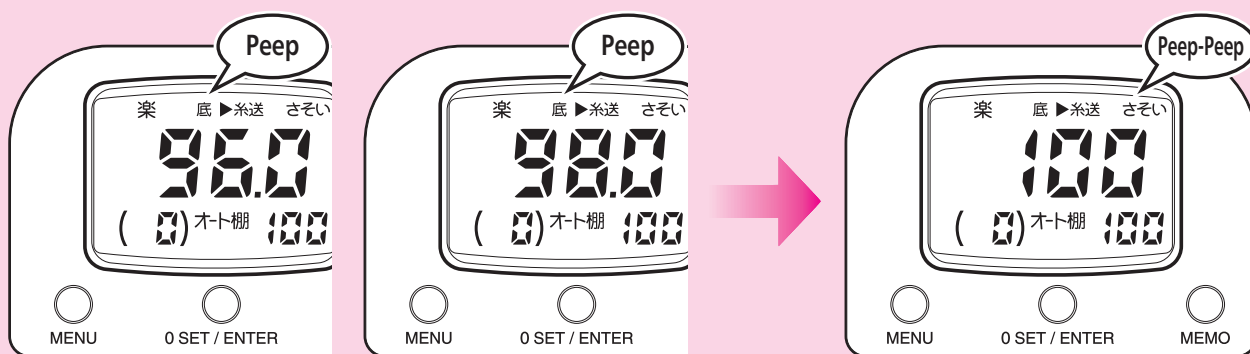

1 When lowering the hook the alarm will sound (peep) every 2m from 4m before the saved depth.

2 At the saved depth (in this case 100m) the alarm will sound (peep-peep).

The alarm will only sound only once in each cast.

Finding the Target Depth



Choose between Top-Down and Bottom-Up Modes

The secret to improving your catch is being able to accurately position your rig at the depth where the fish are.

With the latest high-performance fish finders it is possible to see the exact depth that the fish are at. The skipper of the vessel will normally give you this information.

Depending on factors such as fishing ground,

fishing technique and target species, this position may be given as the distance from the surface or the distance from the bottom.

This reel is ideally suited to either situation as it has both a Top-Down Mode and a Bottom-Up Mode.

Select between modes according to the situation at hand.

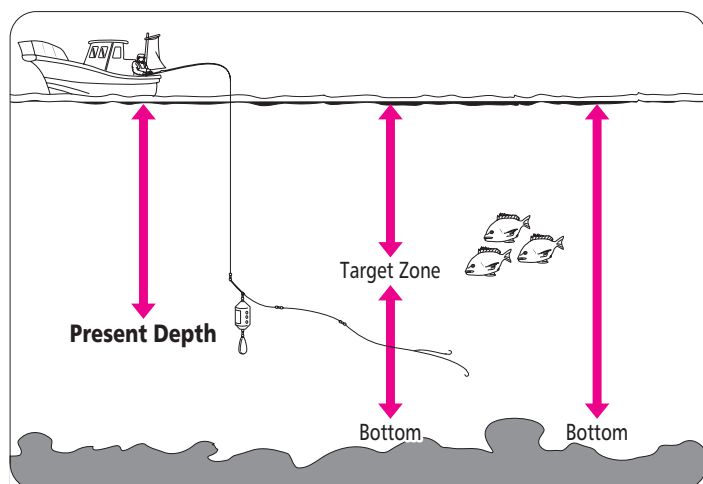

Changing Mode

When the power is turned ON the reel will be in Top-Down Mode. Use the procedure shown below to change modes.

1. When the motor is stopped in Standard Mode, press Menu once.
底 (Bottom-Up Mode) will flash.
2. Press Enter and ▶ will be displayed next to 底 to indicate Bottom-Up Mode. Repeat the procedure to select to Top-Down Mode.

Please see Pages 12~13 for details regarding menu button operation.

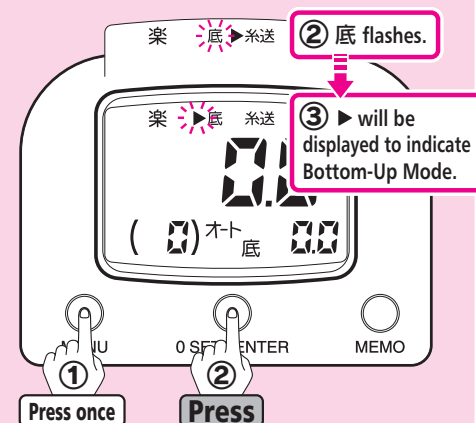

Top-Down Mode Example

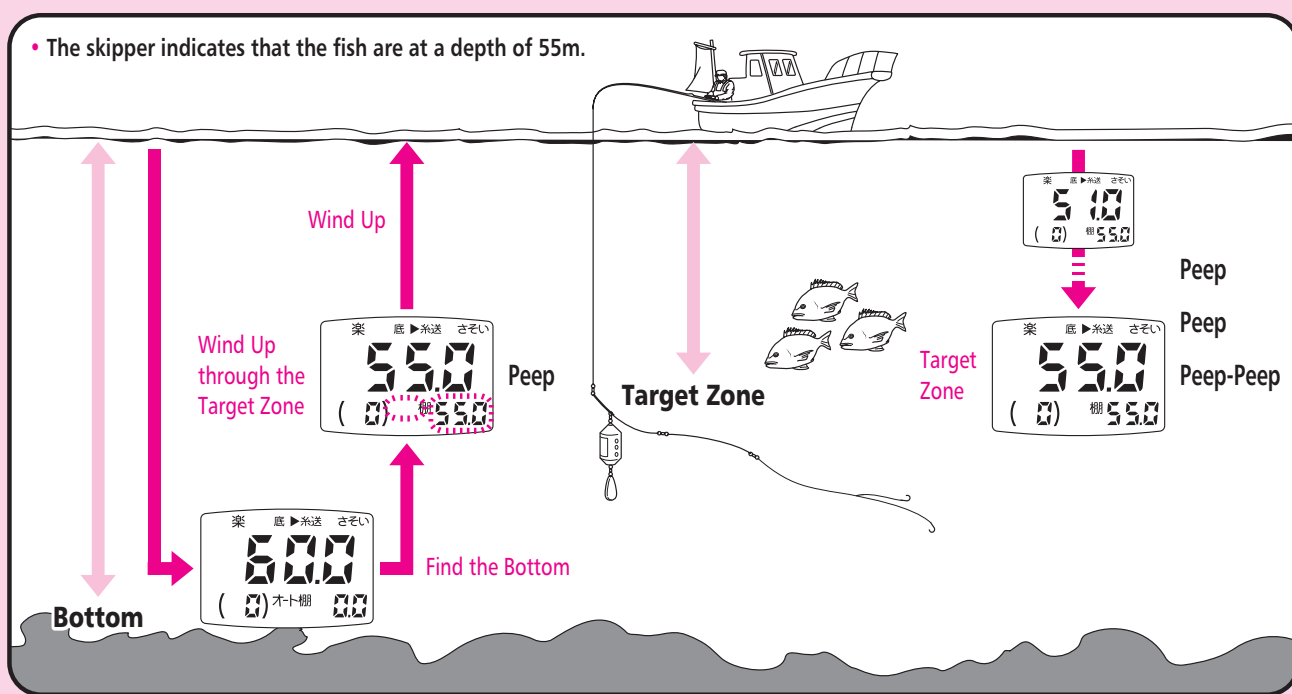

- 1** Allow the rig to drop to the bottom.
- 2** Wind the rig up to the target depth.
Press Menu to save the target depth.
The above procedure is used when you want to know the depth of the bottom. However, it is also possible to drop the rig to the target depth and then press Memo to save that depth.
- 3** On subsequent drops the alarm will sound when the rig reaches the saved depth.

Bottom-Up Mode Example

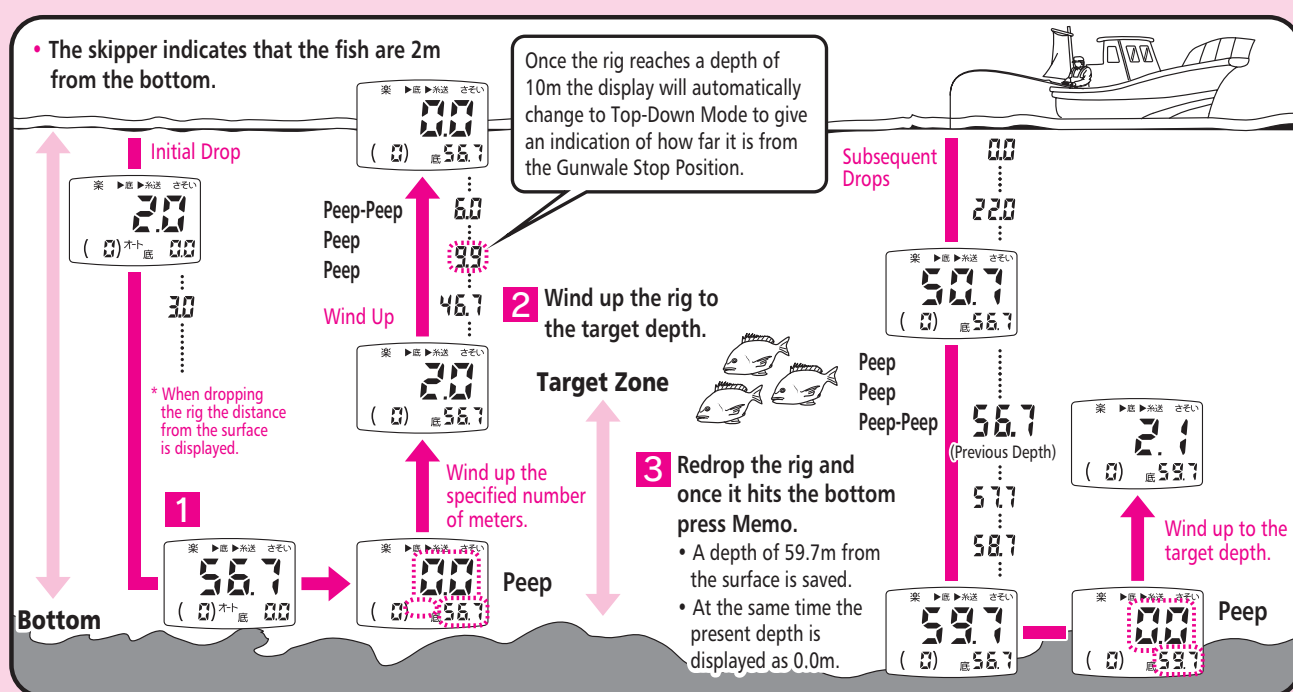

- 1** Allow the rig to hit the bottom and then press Memo.
 - The depth from the surface is saved.
 - The present depth is displayed as 0.0m. When you wind up the rig the depth from the bottom will be shown as a positive number on the display.

Explanation

When the skipper says the fish are a certain number of meters from the bottom, lower the rig to the bottom and the wind it up the required number of meters. (Normally bait is scattered at this time.)

Winding In: Rakuraku Mode | Fixed Speed Mode



1 Changing between Rakuraku Mode and Fixed Speed Mode

- The reel will start up in Rakuraku Mode.
- Press Menu for more than 3 seconds to change between Rakuraku Mode and Fixed Speed Mode. You can change modes when winding in.
- The current mode is shown on the display.
Rakuraku Mode: Green backlight. (楽 is displayed.)
Fixed Speed Mode: Orange backlight. (速 is displayed.)

2 What is Fixed Speed Mode?

Regardless of the size of the fish, or in other words the load on the reel, Fixed Speed Mode adjusts motor settings to wind in your fish at a set speed*.

* Speed is the spool rotation speed of the spool.

Present Mode

Rakuraku Mode: Green backlight (楽 is displayed).
Fixed Speed Mode: Orange backlight (速 is displayed).

Shows the position of the Technical Lever.

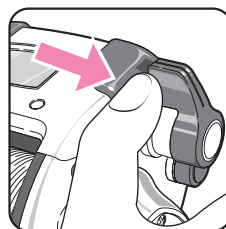

Technical Lever

Used to set Fixed Speed Mode and Rakuraku Mode.

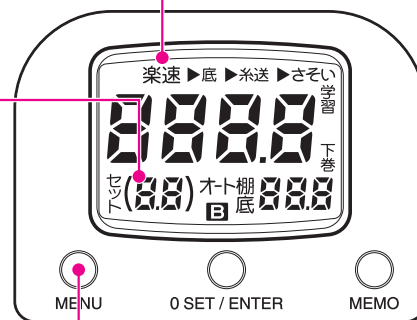

Rakuraku Mode |

Fixed Speed Mode Button

Used to change between Rakuraku Mode and Fixed Speed Mode.

(Continued on the next page.)

3 What is Rakuraku Mode?

Rakuraku Mode maintains line tension at the level you set. In other words, the reel senses the tension (load) on the line and automatically adjusts motor rotation speed to maintain a constant tension.

In other words...

| | |
|---|--|
| <ul style="list-style-type: none">• It avoids the tug of war that occurs between the motor and the fish. | <ul style="list-style-type: none">• This is particularly useful when fishing in rough water where it is impossible to maintain a constant tension on the line manually by using the rod. |
| <ul style="list-style-type: none">• It adjusts motor speed to compensate for sudden changes in tension caused by the movement of the fish and the vessel. | <ul style="list-style-type: none">• The motor takes up any sudden slack in the line when tension decreases due to factors such as when the rod is lowered during pumping. |
| It makes reeling your fish in so easy that you just need to enjoy your fishing. | |

It also has the following advantages...

- It can handle any kind of fishing other than live bait fishing. Rigs with only a light load can be recovered at maximum speed without having to worry about adjusting motor speed, which makes life easy and means that you can concentrate on fishing.
- Adjust tension can quickly and easily using the Technical Lever.
- Maximize rig strength by eliminating the tug of war that occurs between the motor and the fish.

Setting Rakuraku Mode



- Settings are adjusted using the Technical Lever (see the previous page for details).
There are **31** tension settings that can be selected using the Technical Lever.
These are displayed as shown in the diagram.
- Settings **1~4** are for dead slow.
At some tension setting the weight of the sinker can stop the rig from being wound in. In such cases increase the tension.

* The factory settings are the same as Rakuraku Mode.

Jigging Mode



The reel can replicate the popular jigging function.

This is particularly handy when you want to fish all day using this technique.

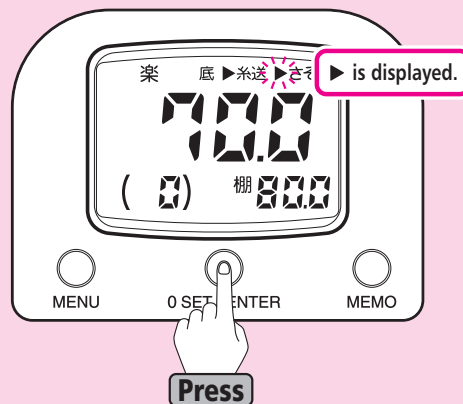
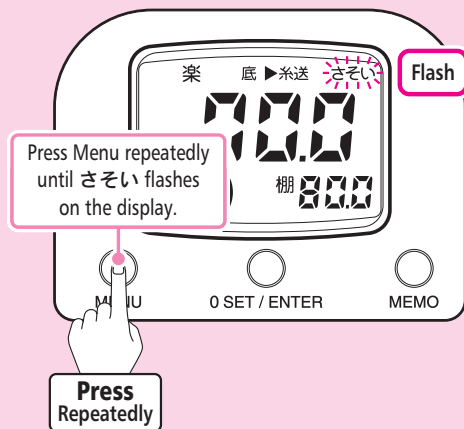

- 1 With the motor stopped and the reel in Standard Mode, press Menu repeatedly until さそい flashes on the display.

Caution:

The settings and values shown on the display are for illustration purposes only. Actual settings and values may differ.

- 2 Press Enter and ▶ will be displayed to indicate that Jigging Mode is ON. Carry out the same procedure again when you want to turn Jigging Mode OFF.

Please see Pages 12~13 for details regarding menu button operation.

Caution

Always check that Jigging Mode is turned OFF before adjusting Smart Line Depth. If it is ON and jigging starts, then the line can be wound in and cause unforeseen injuries.

(Continued on the next page.)

Caution: The settings and values shown on the display are for illustration purposes only. Actual settings and values may differ.

Start Jigging

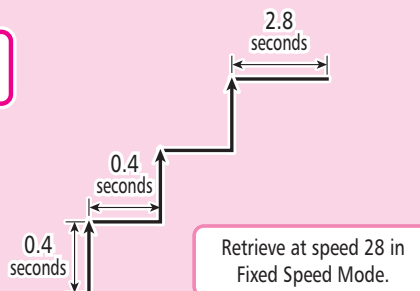

- 3** Press Enter again to repeat jigging in Jigging Mode. Press Enter again during jigging to stop and start jigging. さそい will flash during Jigging.

- * If you start to retrieve your rig using the Technical Lever during jigging then jigging will be cancelled.
- * The motor will stop after the Gunwale Stop.

Caution

Do NOT press for more than 3 seconds.

If you press Enter for more than 3 seconds then the reel will adjust the Smart Line Depth and an error will be shown on the display. If this happens, either carry out Line Learning again or wind the rig in manually until it gets to the surface and then reset 0m. (When carrying out this at 65m as shown above, the display will show -65m when reset.)

Handling Instructions

This reel consists of precision electrical components. Please read and follow the instructions below. Proper maintenance after every fishing trip is recommended to ensure that you will be able to enjoy using the reel for many years to come.

1 Caring for Your Reel

* Remove the power cord and make sure that the reel has completely cooled down before you start any maintenance.

1. Tighten the drag.
 2. Wash the outside of the reel with water, using a wet sponge to remove any dirt.
- * Do not immerse the reel in water.
3. Disengage the clutch to let out 2~3m of line while washing between the spool and reel to get rid of the salt as shown in the diagram.
 4. Loosen the drag completely and leave the reel to dry in a shady place.

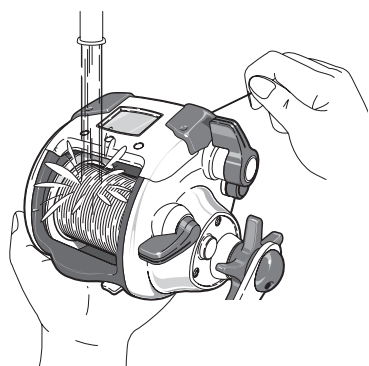

* Wash or lightly brush the alligator clips using freshwater to get rid of any impurities from seawater.

* Salt Build-Up in the Bearings

While Anti-Rust Bearings are especially resistant to salt water, they are not, however, designed to prevent salt water from penetrating inside the bearings. If basic maintenance is neglected, seawater may remain inside the bearings and when it dries it may cause the bearings to run roughly or seize. Although in such a case the bearings will not rust, the reel will run roughly and noisily in the same

way as if the bearings were rusty. It is almost impossible to remove dried salt from inside the bearings and even though Anti-Rust Bearings are used there is no alternative other than to completely replace the bearings. Please bear this in mind when using your reel. We strongly recommend that you have maintenance carried out on a regular basis.

* Please detach the power cord from the reel when in storage.

2 Cleaning Your Reel (When you notice a deterioration in spool rotation.)

- If the spool is not rotating as smoothly as usual even after normal maintenance then this may indicate that there is a build-up of salt in the bearing near the handle.

* Remove the power cord.

1. Carefully immerse the reel in freshwater up to spool as shown in the diagram. Do NOT immerse the whole reel. Rotate the spool to dissolve the salt and regain performance.

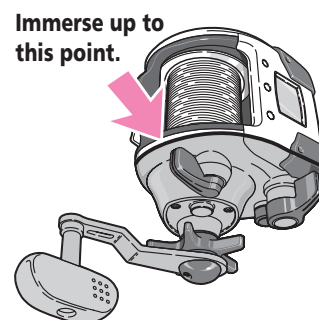

2. Remove the reel from the water and hold it up with the connector side facing down to ensure that the water completely drains from inside the reel.

If that does not improve the situation, please contact your nearest sales office to have the reel overhauled.

(Continued on the next page.)

3 Precautions

- One of the characteristics of powered reels is that even though the motor is ON, sometimes line will not get wound in if a fish is hooked because the drag is slipping. This is similar to an automobile going along with the handbrake on. If this goes on for a long time, then the oil in the drag will be burn off and eventually the drag will burn out. Take care not to allow this to happen as it could destroy the entire reel.
- When the line is caught, do NOT exert excessive force on the rod or reel. Instead, please cut the line after taking care to minimize the amount of line left in the fishing ground.
- Please take care when handling the reel. Never throw it in your bag or allow it to bang against other items during transportation.
- NEVER drop or hit the reel. Treat it carefully.
- Take care not to hit the back of the reel or bend the power cord when putting the reel into a rod stand. Take special care not to trap the power cord between the reel and the gunwale.
- Some types of polarizing sunglasses make it difficult to properly view the display.
- After winding in a heavy load, take care when dropping the rig and winding it in the next time as the rig may get tangled with the tip of the rod.
- If the resin footing of the reel is secured to a metal reel mount, this may damage the resin and can ultimately damage the whole reel. Please make sure the resin protector is properly in place when attaching the reel to a metal mount.

4 Maintaining Your Reel

- **Regular Maintenance - Please contact your nearest service center.**
The condition of the reel is greatly influenced by not only frequency of use, but also the environment in which it is used, how it is used and the target species. If any abnormality is detected, please contact your nearest service center through the nearest retailer immediately. A regular professional maintenance check once every six months is highly recommended.
- Always remove the power cord from the reel before storing it.
- Place the protective cap on connectors when the reel is not in use.
- NEVER try to disassemble the reel as this can damage internal electrical components such as the motor and circuit breaker and may cause the reel to malfunction.
- NEVER oil the drag mechanism as this may decrease performance.
- Leaving the reel in high temperature, high humidity conditions for a long period of time may cause deformation or weakness. Always store in a cool, dry place after carrying out regular maintenance.
- NEVER immerse the entire reel in water, especially the display. (Although the display is shower proof it is best to avoid immersing it in order to prevent any trouble.

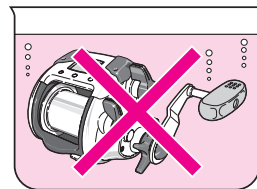

- Please use Shimano Reel Grease to extend the life of your reel.
Apply the grease at the locations shown in **Figure 1** and **2**.

Shimano Genuine Reel Grease Spray (SP-023A)

Figure 1. The end of the power cord.

It is more effective to apply grease to the terminals in the socket of the reel.

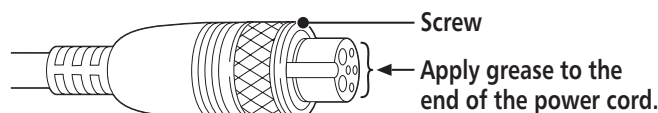
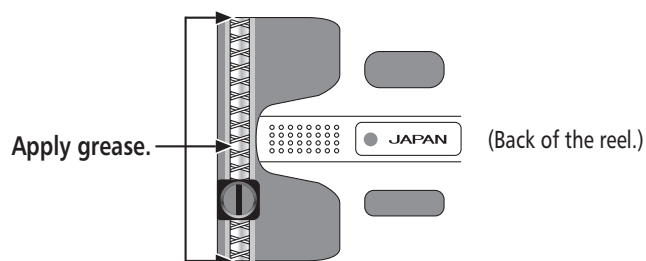

Figure 2. The worm shaft and sides of the worm shaft.



5 Safety Features

● Automatic Circuit Breaker

The motor will turn ON and OFF at 1 second intervals if there is excessive load on the reel. This is normal.

When that happens, the circuit breaker will trip and the display will flash. Leave it flashing for 5 minutes to protect the motor. Learning data will be saved even if the line is wound in or fed by hand. The motor will start to operate again when the flashing stops.

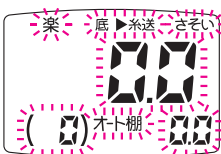

● Battery Status Display

When battery voltage drops below 10.5V (13.5V for the lithium-ion battery), or when the power cord is not properly connected, the battery icon will be displayed. Check the connection first. If there is no problem with the connection then the battery will need to be charged.

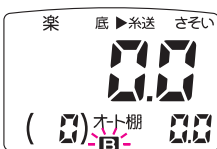

● Technical Lever Breakage

Please refer to the **Inquiries | After Sales Service** section to have the unit repaired if this error message is shown in the display.

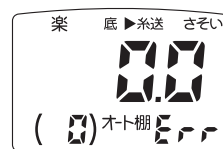

* Do NOT wind or unwind the line when this **Err** error message is displayed. Line Learning will be inaccurate.

● If Voltage is Too High

This error message will be displayed if a voltage of more than DC28V is applied. Please check the power source and make sure that it provides between 12V and 14.8V



● Inaccurate Line Learning Operation

This error message indicates inaccurate Line Learning. Carry out Line Learning again.



Specifications

1 DENDOUMARU 1000 PLAYS specifications:

| Maximum Winding Strength | Maximum Drag | Maximum Winding Speed | Actual Winding Speed | | | Actual Maintainable Winding Strength |
|-------------------------------------|--|--|--|--|--|--|
| <div>25.0 kg</div> <div>241 N</div> | <div>5.0 kg</div> <div>49.0 N</div> | <div>185 m/min.</div> | <div>1 kg (Load)</div> <div>146 m/min.</div> | <div>2 kg (Load)</div> <div>136 m/min.</div> | <div>3 kg (Load)</div> <div>116 m/min.</div> | <div>4.2 kg</div> <div>41.2 N</div> |
| Reference | Maximum drag for Shimano boat reels is the drag produced when a person pulls the reel with one hand. | Retrieval speed when winding the line in with no load. | The time required for bringing a rig to the surface from 100m. Actual winding speed is for example, is the speed at which a specific load can be reeled in from 100m at maximum speed using a #1000 series reel with 280m of POWER PRO 0.32 diameter line. Measuring Conditions: A 12.5V power supply at 15~20°C. (Speed will be higher if a higher voltage lithium battery is used.) * Measurements may fluctuate according to the environment in which the reel is used. | | | The winding strength that can be maintained for an extended period of time. The actual maintainable winding strength is the weight of the load when the circuit breaker actually trips under the gradually increasing load. |

| Model Number | Product Code | Gear Ratio | Weight (g) | Line Capacity (diameter-m) POWER PRO | Winding Capacity (cm/1 handle rotation) | Spool Dimensions (diameter/width (mm)) | Handle Length (mm) | Bearing Number (balls/roller) |
|-----------------------|--------------|------------|------------|--|---|--|--------------------|-------------------------------|
| DENDOUMARU 1000 PLAYS | 51RG241000G | 3.9 | 545 | 0.19-465, 0.23-390 0.32-280, 0.36-275 | 60 | 49/39 | 60 | 2 A-RB / 1 |

- **Standard Accessories**

Power Cord, Operating Manual, Component Diagram, Line Threading Pin, 10m line
- **Power Supply (DC Only)**

DC12V (Compatible with lithium batteries.)
- **Caution**

Take care not to cause backlash or the line may be caught between the spool and the frame.

2 DENDOUMARU 4000 PLAYS specifications:

| Maximum Winding Strength | Maximum Drag | Maximum Winding Speed | Actual Winding Speed | | | Actual Maintainable Winding Strength |
|--------------------------|--|--|---|----------------------------------|----------------------------------|---|
| 48.0 kg 467 N | 15.0 kg 147 N | 160 m/min. | 1 kg (Load) 131 m/min. | 2 kg (Load) 122 m/min. | 3 kg (Load) 120 m/min. | 10.0 kg 98.0 N |
| Reference | Maximum drag for Shimano boat reels is the drag produced when a person pulls the reel with one hand. | Retrieval speed when winding the line in with no load. | <p>The time required for bringing a rig to the surface from 100m. Actual winding speed is for example, is the speed at which a specific load can be reeled in from 100m at maximum speed using a #1000 series reel with 280m of POWER PRO 0.32 diameter line.</p> <p>Measuring Conditions: A 12.5V power supply at 15~20°C. (Speed will be higher if a higher voltage lithium battery is used.)</p> <p>* Measurements may fluctuate according to the environment in which the reel is used.</p> | | | <p>The winding strength that can be maintained for an extended period of time.</p> <p>The actual maintainable winding strength is the weight of the load when the circuit breaker actually trips under the gradually increasing load.</p> |

| Model Number | Product Code | Gear Ratio | Weight (g) | Line Capacity (diameter-m) POWER PRO | Winding Capacity (cm/1 handle rotation) | Spool Dimensions (diameter/width (mm)) | Handle Length (mm) | Bearing Number (balls/roller) |
|-----------------------|--------------|------------|------------|---|---|--|--------------------|-------------------------------|
| DENDOUMARU 4000 PLAYS | 51RG244000G | 3.2 | 1,230 | 0.32-680, 0.36-675 | 68 | 68/61.5 | 75 | 2 A-RB / 0 |

● Standard Accessories

Power Cord, Operating Manual, Component Diagram, Line Threading Pin, 10m line

● Power Supply (DC Only)

DC12V (Compatible with lithium batteries.)

● Caution

Take care not to cause backlash or the line may be caught between the spool and the frame.

Troubleshooting

| Situation | What to do | Reference |
|---|--|-------------------|
| The display is black or shows all characters. | This happens when the unit is left somewhere at high temperature, such as in a car boot. It will return to normal when the temperature goes down. | |
| Nothing appears on the display. | Check to see if the (+) and (-) of the power cord are connected properly to the battery. Check to see if the battery has sufficient charge. Check the surface of the alligator clips for foreign objects. | P.14~P.15 |
| Nothing appears on the display (when used in extreme cold). | When the LCD display is left in extreme cold (below -15°C), the display will not work for a while even though the power is turned on. Wait until the circuit board inside the unit warms up. When fishing in extremely cold conditions, it is recommended that the reel be kept in the cabin or under cover until it is needed. | |
| Line Learning cannot be set. | Please try the Line Learning process again. | P.16~P.27 |
| The numbers on the display do not change even when line is fed out. | Please try the Line Learning process again. | P.16~P.27 |
| There is too much discrepancy. | Please try the Line Learning process again. | P.16~P.27 |
| The number on the display does not match the line depth marks. | Depending on the type of line, sometimes the line gets stretched, which can cause discrepancies on the display. | |
| The Gunwale Stop position is wrong. | This is probably due to winding tension or stretched line. Carry out 0 set. Gunwale set is only possible between 1~6m. Settings between 0~1m are rounded up to 1m for safety reasons. | P.32~P.33 P.36 |
| The display is working but the motor is not. | Check if the battery has enough charge. When the battery does not have enough charge, the motor may work at low speed but not at high speed. Charge the battery and test the reel. If that does not improve the situation, you may need a new battery. The motor may not work when the temperature of the reel is below 0°C. When fishing in extremely cold conditions, keep the reel in the cabin or leave it ON until it is needed. Furthermore, the motor does not start when the display shows less than 1m for safety reasons. | P.14 P.11 |

| Situation | What to do | Reference |
|--|---|-----------|
| The motor stops while winding. | Make sure all the screws on the power cord connector are at the connector. If the boat's power supply terminal or the reel's power cord connector is rusty, the current will not flow properly. Remove any rust and try again. Battery charge should also be checked. | P.14 |
| There is a strange sound in the reel even when not winding. | A condenser is installed under the display unit to protect the reel from fluctuating current. The condenser may vibrate and make some noise when the reel is used with an unstable power supply. However, this will not affect reel function so it is OK to keep on using it. | |

In order to enjoy fishing, please turn the power on and check the performance of the reel before you go.
(The motor does not come on unless the line is fed more than 1.1m.)

If above checks still do not improve the situation, please contact the retailer you purchased the reel from and explain the problem in detail.

Product Inquiries /After Sales Service Information

Please include your telephone number when you send us an inquiry by mail.
It is easier to explain some reel mechanisms on the phone rather than in writing.

- When the reel needs repairing, please take it to the retailer you purchased it from together with the guarantee and the power cord. We need to know detail regarding the problem. (E.g. The stopper does not work.)

A charge will be made for the necessary replacement parts and labor. We cannot compensate for damaged or lost tackle arising from a damaged Shimano product and/or fishing trip expenses.

- If you wish to order a part or replacement spool, please order from the place of purchase or your nearest retailer, specifying product name, merchandise code/product code, part name/number as shown in the component diagram. (We recommend sending in the whole reel for the repair.)

Example/

Product Name: DENDOUMARU 1000 PLAYS

Product Code: 51RG241000G

Part Number: 2

Part Name: Handle

- Shimano retains fundamental parts (i.e. the parts necessary to maintain the function of the product) for fishing rod for up to 6 years after the manufacturing of a particular model is stopped. We may not accept a request for the repair if parts are not available. Some other minor parts may not be provided even if it is less than 6 years since the manufacturing of the product has been stopped.

● Product Code

The top five digits of the product code is recorded on the instruction manual, component diagram, and bottom or side of the package.

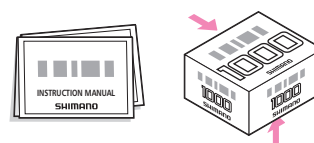

Service network

SHIMANO

SHIMANO EUROPE FISHING HOLDING B.V.

Industrieweg 24, 8071 CT Nunspeet, The Netherlands Phone: +31-341-272233

SHIMANO GERMANY FISHING GMBH

Diessemer Bruch 114 F, 47805 Krefeld, Germany Phone: +49-2151-55670

SHIMANO U.K. LTD.

Unit 1A, Vale Park Business Centre, Vale Park, Evesham, Worcestershire WR11 1GD, United Kingdom Phone: +44-1386-425824

SHIMANO ITALY FISHING S.R.L.

Via Privata Maestri del Lavoro 29, 20025 Legnano Milano, Italy Phone: +39-0331-742711

SHIMANO AMERICAN CORPORATION

One Holland, Irvine, CA 92618 U.S.A. Phone: +1-877-577-0600

SHIMANO CANADA LTD.

427 Pido Road Peterborough, ON K9J 6X7, Canada Phone: +1-705-745-3232

DUNPHY HOLDING PTY. LTD.

36 Bay Road, Taren Point, NSW 2229, Australia Phone: +61-2-9526-2144

SHIMANO (SINGAPORE) PTE. LTD.

20 Benoi Sector, Jurong Town, Singapore 629852 Phone: +65-6265-4777

SHIMANO INC.

3-77 Oimatsu-cho, Sakai-ku, Sakai City, Osaka 590-8577, Japan Phone: +81-72-223-3467

www.shimano.com



11

PRINTED IN JAPAN
IMPRIME AU JAPON

SHIMANO

• Line Threading Pin

(110218)