

INSTRUCTION MANUAL



Thank you for buying electric reel of banax.

Please be aware of the instructions before use, and we ask you to use it according to the safe and correct method of instructions.

Also please keep this manual with reel because this includes very important details about the reel usage.

CONTENTS

- | | | | |
|---|---|---|---|
| 1. Caution for safety
----- P2 | 6. Each part's description
of control box ----- P8 | 8. Operation method
* The sides of boat's automatic stop
--- P16~17 | 9. Safety function
--- P24~25 |
| 2. Attention of handling
----- P3~4 | 7. Preparation before use
* Power supply connection method
----- P9 | * The surface of water "0" setting up
--- P18~19 | 10. When fault is doubtful
----- P26 |
| 3. Handling method of reel
----- P5 | * Fishing line data input method
--- P10~15 | * Shelf mode ----- P20 | 11. Part list
----- P27~28 |
| 4. Primary function and
characteristics ----- P6 | | * The low mode
----- P21~22 | |
| 5. Handling method of reel
----- P7 | | * Correction of original line cut
----- P23 | |

CAUTION FOR SAFETY

● Must read before using ●

⚠ Warning



- Make sure not to get caught a finger between Level wind and body.
- When using power from the battery, do not use power more than certain voltage (DC12~14.8V). If it is used with power more than certain voltage, it could lead to burn by heat or damage on electric parts.
- Because of minute electromagnetic wave, palpitation or dizziness could happen from malfunction of medical device such as hearing aid and pacemaker. So please check with relevant medical institution.

⚠ Caution



- When line is released or wound, do not hold the line with hand. Hand or finger could get hurt by line.
- Do not touch the spinning part of reel. There is possibility for injury.
- If there is water drop or moisture on LCD, motor could not be controlled because of malfunction. Please stop using right away and ask for repair.
- If you can smell something burning or see smoke from the reel, please remove the power immediately. It could ignite or motor could not be controlled.
- When plated or painted surface is peeled off, the part could be sharp. Please do not touch because there is possibility for injury.
- While using, LCD screen could be blacked out because power code is fallen out or any other reason. If handle is used in this situation, there would be difference on line counter after screen comes back. And it could break the rod by equipment pulled to rod. So please pull the line with care for tip section of rod when the screen has blacked out.
- Please do not place or use the reel where infants could reach.
- When cleaning or mending, proceed after making sure on removing power cord. Injury or reel damage could happen if the motor works incidentally.



- Before connecting the power, be sure to loosen the drag sufficiently.
- When it goes wrong, motor could rotate and it would break the rod by equipment pulled to rod.



- Do not dismantle or transform the body. It could affect to the performance or cause break down of reel.

Attention of handling

1 Regarding power supply

Power supply is D.C 12V (exclusive use). It's not available for you to use others (A.C 110V or 220V for home, D.C24V for ship) except the designated power supply.

- Low volume battery can not show the electric reel's capacity normally owing to the sudden drop of electric pressure. We advise you to use the battery over 1000mAh.
- Because 12V power supply have a occasion that the voltage is unstable according to the state of wiring or generator, normal performance is impossible because the protection channel of this occasion reel operates or there is occasion that operation is suspended. Please use the exclusive battery only for electric reel.
- Please use fully charged battery.
- Because applying an electric current badness happens by rust etc.of terminal, there is normally malfunctioned. After cleans cleanly or removes the rust in case of rust etc. Please use.



DC 12V
(1000mAh)



AC110V, 220V



DC24V



Please confirm below list before leaving



- If the battery leave alone for a long time, it is possible that natural discharge can lower the capacity. Before leaving, make sure the battery is certainly charged.
- In power supply of boat, there is an occasion that use is impossible by connecting terminal shape etc. We'll encourage something to confirm before use.

Attention of handling

2 Regarding power supply cord

- Connection of power certainly uses supply cord that is enclosed with reel in package box.
- If you remodel supply cord connection etc. except pure attachment, reel can malfunction normally when use supply cord.
- You don't handle violently sources of electricity cord.
If you wind it disorderly on the reels or step it or fold and bend it, those actions can cause failure such as a disconnection.
- After using, clean the contaminated parts with a soft towel which is wet with water and dry and keep it.
(Don't wash under the water.)
- When you need to pull out the cord, certainly have to seize connector parts.
- Please store or move the power cord after removing from the reel.

3 Regarding reel's main body

- In case the fishing line is hooked a obstacle on the bottom, you don't pull the fishing rod or reel by constraint.
- Please handle carefully in order not to get an impact such as dropping.
- When setting up fishing rod holder,
please observe especially not to be impacted to back of reel and supply cord.

3

Handling method of reel

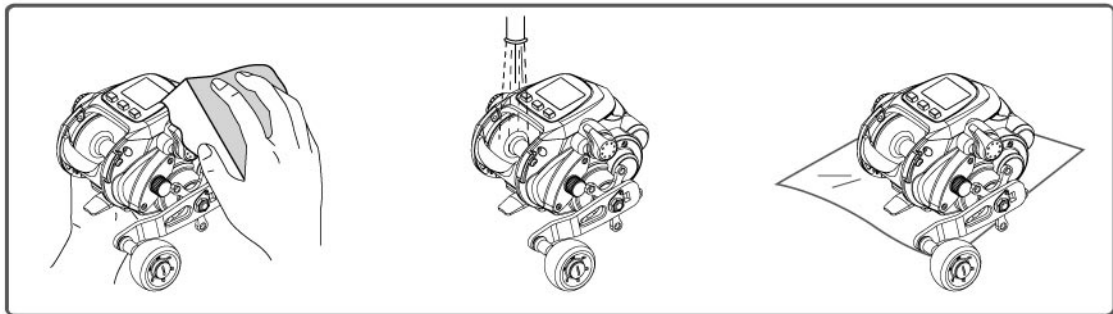

- 1** Please clean the contaminated parts of reel's body with a sponge or towel which is wet with a detergent.
- 2** Remove a detergent and contaminated material by spraying water. Remove also the salt on the spool part by spraying water.
- 3** After removing the moisture, dry it in the shade.



Attention

- Please use a neutral detergent.
- Please do not wash reels by soaking to the water.
- In case of leaving at a humid place, this can cause modification or quality deterioration. After washing, keep it in dry place with high temperature.
- Never oil in the drag part.
This can cause power deterioration or trouble.
- When you do not use please put on connector cap, for connector protection.
- Do not use anti-rust additives or lubricant which is commonly used.
It could be cause of breakdown.

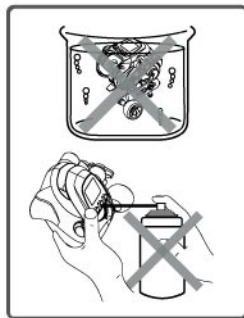

Primary function and characteristics

Speed lever	Motor operation, drag speed/power could be adjusted by controlling lever.
Carbon drag	Carbon which is strong for non-slip • power • durability is used for drag.
Jigging	Motor works only while the switch is pushed. It is convenient to wind loosen line and attract fish. (Change on speed is not possible)
Speed dial	Same function as speed lever, but it could be operated with finger from the hand holding the reel.
Perfect spool free	Spool is completely free with gear by clutch off, It makes easier to drag down even the light lure and equipment.
Return lever	Prompt clutch ON is possible
Auto stop	Place of stop could be set up according to the rod or equipment.
Setting up the surface of water	More specific swimming zone could be targeted by setting surface of water as 0m.
Setting swimming zone	If set the depth where fish had caught, alarm rings when dragging down the equipment.
Swimming zone auto setting	Swimming zone where fish had caught could be checked and set after dragging up.
Bottom mode	Marking the place of equipment on the bottom of water.
Correction of line cut	When line is cut off, line data is revised.

5

Each part's name & function

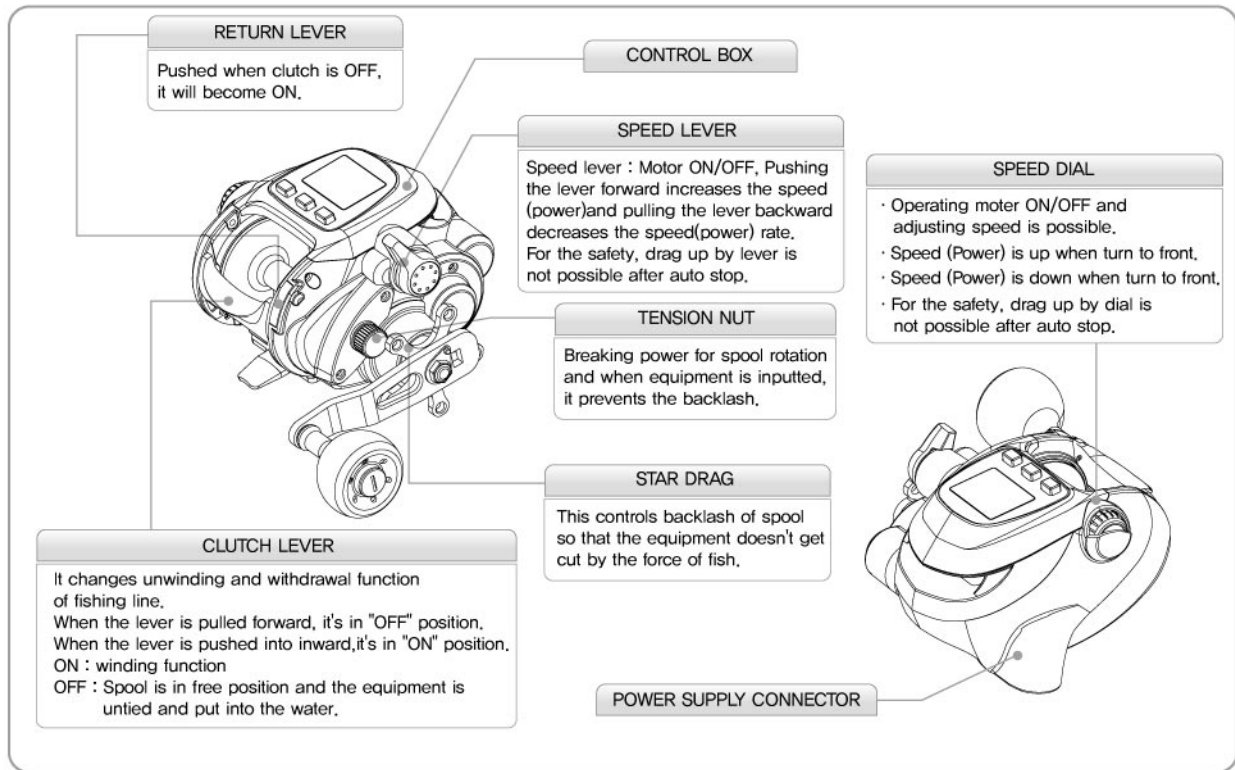

Each part's description of control box

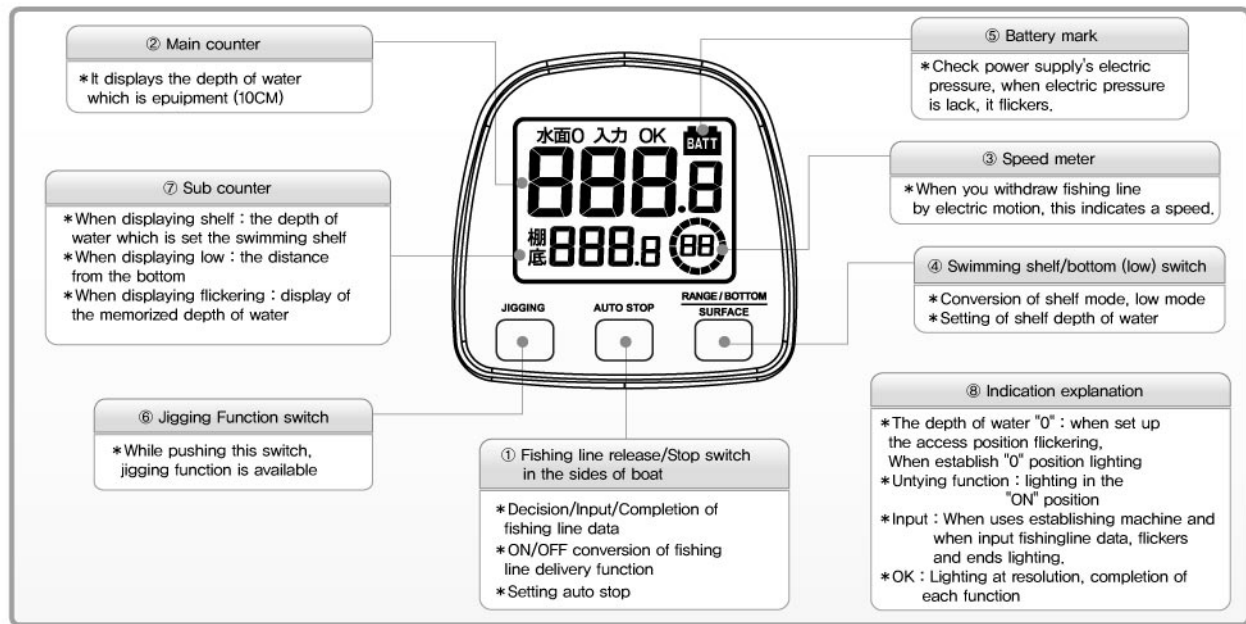

Attention

- ① It displays a liquid crystal screen with lighting in the picture for explanation.
- ② In the counter indication , below -10°C ~ over 60°C , there is a difficulty in interpretation because of special characteristic of liquid crystal Please be aware of this point.

Preparation before use

Power supply connecting method

- ① Please connect power supply's clip in battery.
Connect plus terminal – red clip and minus terminal – black clip (refer to picture1)
- ② Put in deeply and assemble the power supply's "parts and fix it certainly by a nut," (refer to picture 2)
- ③ – 1 if it's connected exactly, displayed the initial.
- ④ – 2 if fishing line's data is inputted, display like picture 4 after setting screen.
- In (picture 3) (picture 4), battery mark is flickering but if electric pressure is normal, it will be disappeared in 5 minutes. In the event, battery mark is not disappeared. There is possibility of drop for electric pressure. Please exchange it or charge it.
- In the event of (picture 4 : input completion of fishing line data), it is impossible to wind automatically within the sides of boat stop(5M) for safety. ON/OFF switch does not work.
- * Indication is established by 5M in case that do not establish a part
- * If you have signed the depth of water's indication more than 5M, an automatic winding is possible.

Picture 1



Picture 2



Picture 3



Picture 4



Attention

- * If you connect the power supply again, it works back-up function.
- * After disconnection, if you reconnect within 15 minutes, there is no back-up but no problem.
- * If you connect the power supply within 5 minutes again, setting screen doesn't come up, but there is no problem.

Preparation before use

Fishing line data input methods—A

- * Input a data by winding fishing line on the reel.
- In case of using a inputted fishing line data.
 - * Below 6 kinds of line data is saved in this reel.

PE4-400m PE5-200m PE5-300m PE6-200m PE6-300m PE8-200m

- ❶ Please connect the fishing line to the spool by passing level wind.
- ❷ Please confirm picture 5's displaying image after connection.
- ❸ Push the shooting out switch and the sides of a boat switch coincidentally for 3 seconds. It displays like (picture 6).
- ❹ Push the shooting out switch and select your fishing line's number and length (picture 7).

Picture 5

Picture 6

Picture 7

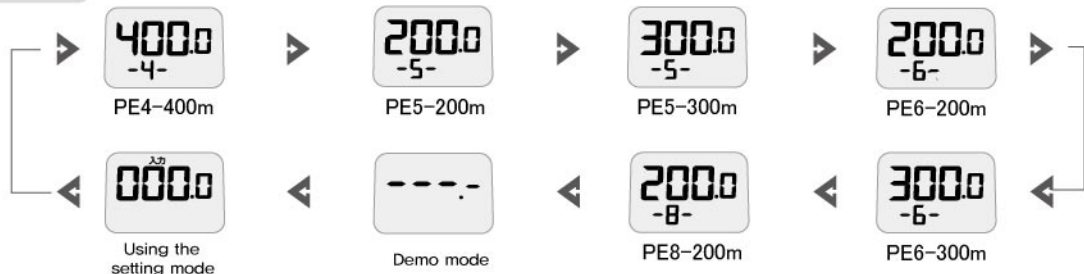

7

Preparation before use

- 5 Please push the on/off switch and wind the fishline after you confirm whether fishline to be wound and selected fishline data is correct.
- 6 The motor will automatically be stopped in front of selected fishline's 15M. After the motor is stopped, please wind the rest of line by using jigging function switch or handle.
(please be careful that the line should not get into)
- 7 When you finish the winding, push the depth of water "0" switch and complete the input.
The LCD change as below procedure [picture 8]

Picture 8

- In the case of winding PE 6 line 300m.



Winding completion

Push Swimming shelf
Bottom(low) switch

Setting screen



The input is completed



Attention

- 1 When you wind the fishing line, you need to give the load of 1.0kg ~1.5kg.
- 2 If you push the sides of boat switch in demo mode screen, the set up data will be gone and display the demo mode. Please start from ground zero.
- 3 If any errors is caused during your operation, please push the "swimming shelf / button" switch and finish the working and restart it from the beginning.
- 4 Indication of the depth of water is set below ± 3 , it is possible to happen more than little by the emission range or expansion and contraction.

Preparation before use

Fishing line data input method-B

- you can use this in case that you know the type of line and diameter.
Kinds and size of line those are possible to input are as below
PE-3 / PE-4 / PE-5 / PE-6 / PE-8 / Nylon-6
 - * you can only input the above kind of line & diameter.
- 1 Please connect on spool passing fishline by level wind.
 - 2 Please confirm that screen with [picture 9] is displayed after connecting power.
 - 3 Push "the shooting out in front of boat stop" switch and the depth of water "0" switch coincidentally for 3 seconds. It displays like as [picture 10].
 - 4 Press shooting out switch and select input mode.[refer to picture 7, 11]
 - 5 Please push the jigging function switch and select the type of winding line and diameter or status of the economizing with the extra-line on the spool.
When you push the switch, the indication on the screen is changed[picture 12].

Picture 9

Picture 10

Picture 11

Picture 12

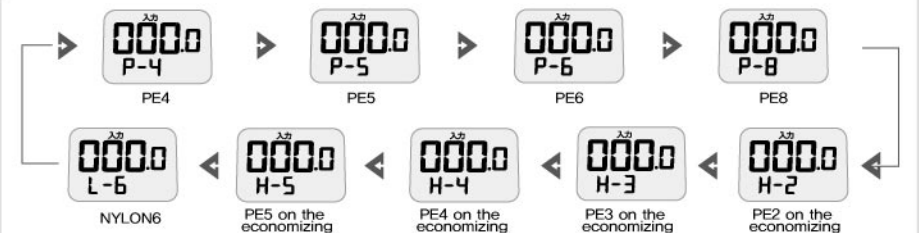

7

Preparation before use

Fishing line data input method-B

- ⑥ please check if it is the setting line and wind the line by controlling speed lever.
- ⑦ After winding the fishing line, please push the depth of water "0" switch [picture 13].

Picture 13



Attention

- ① When you wind the fishing line, you need to give the load of 1.0kg~1.5kg.
- ② If any errors come out during your operation, please finish the working by pushing the "swimming shelf/button" switch and restart it from the beginning.
- ③ Indication of the depth of water is set below $\pm 3\%$, It is possible to happen more than little by the emission range or expansion and contraction.
- ④ Display image is just like -E1- of error, It is short of winding line, so you have to wind the line more than 50m
- ⑤ When display image shows -CE- or -/SE-, the reel has to be repaired, you can contact the shop which you purchased the product.
- ⑥ If display image shows like below during you input the data or complete the input, there may be the fault in your way of input or defect in the Reel.

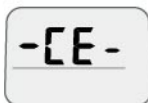

Error in the control box

• Restart from the beginning

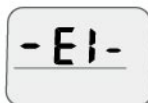

Short of line

• Check the drag position

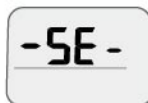

error of spool's rotation

• reset after checking

Preparation before use

Fishing line data input method—C

- * In the case of the line data input after economizing extra line on the spool,
 - * Kinds and size of line those are possible to input after releasing line are PE 2, PE 3, PE 4, PE 5.
 - * Please check the location of economizing of the extra line by the use of the indicating card as in the picture 14.
- ❶ Tie up the economizing line on the spool through the Level wind.
 - * Attach the line at Line fixed pin to prevent the sliding.
 - ❷ Wind the economizing line after turning up the power.
 - * Use the economizing line indicating card and then confirm the location of it comparing main line.
 - ❸ Tie up the main line after finishing winding of economizing line.
 - ❹ Push the "shell/bottom" and fishing line delivery/the sides of boat stop switch for 3 seconds at the same time. (It is displayed as picture15)
 - ❺ You can use the input mode through pushing the fishing line delivery/the sides of boat stop switch. [refer to picture 7, 12, 16]
 - ❻ Select the type of line and diameter of line through pushing the "jigging" switch [picture 17]

Picture 17



Picture 14

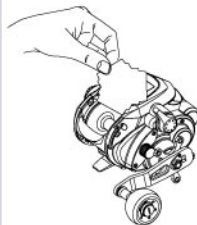

Picture 15

400.0
-4-

Picture 16

Flickering

000.0

入力モード

7

Preparation before use

- ⑦ Wind the Line by controlling the Speed lever.
- ⑧ Turn off the Speed lever and finish the line winding and complete inputting the "shelf/bottom" [picture 18].

Picture 18

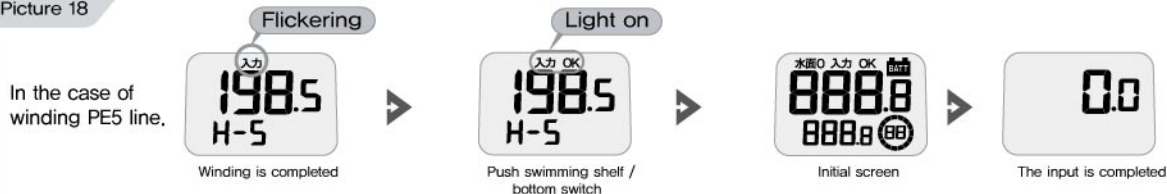

- * Numerical value in the counter is just example.
- * That is not the value same as the real situation.



Attention

- ① When you wind the fishing line, you need to give the load of 1.0kg~1.5kg.
- ② If any errors come out during your operation, please push the "swimming shelf/button" switch and finish the working and restart it from the beginning.
- ③ Indication of the depth of water is set on ± 3 , but it may happen to be error in much range or expansion & contraction.
- ④ When using line below PE 3 size, line could stuck between spool and body because of over wound line or back lash. So please take extra care.

Operation methods

1 The sides of boat's automatic stop

- When you stand up your fishing rods, you need to set up automatic winding function's stop point from hand range to equipment.

Operation sequence ① : Connect the power supply after the delivery fishing line from reels.

Operation sequence ② : In order to reach within one's hand, adjust the length of fishing line.



Push untying / side of boat switch more than 3 seconds



Operation methods

Operation sequence ③ : Push the shooting out switch more than 3 seconds.
If the image is displayed like (picture19),
that means setting up of stop point is completed

- * At this time "the depth of water" will flicker.
- * It is possible that "the depth of water" setting up goes ahead.

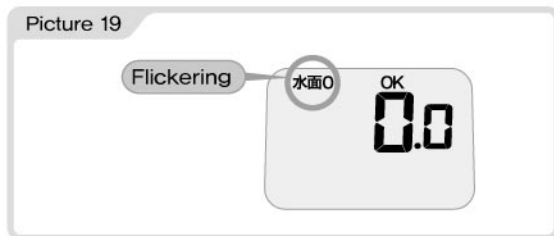

Attention

- ❶ If you input the data to your equipment under the undone the sides of boat setting up, the sides of boat stop position is set up 5m.
- ❷ When you finish completion of input by pushing the shooting out switch, displaying image is just like below, it is possible to input methods errors or control box's errors.
- ❸ When don't set (surface of water "0") during flickering, there is no problem even if do fishing with inputting equipment. (Surface of water"0") is deleted automatically because it is more than counter indication 10.0.

Operation methods

2 The surface of water "0" setting up

- In order to search swimming shelf, you need to set up the surface of the water "0".
- * When you finish the sides of boat stop point, the surface of the water "0" is flickering in the screen. (refer to picture 20)

Picture 20

Flickering

水面0

0.0

Operation sequence ① : First, you stand up your fishing rods and adjust handle in order to come the surface of the water.
When you wind the equipment to the surface of water, the depth of water in the screen shows - 0.0

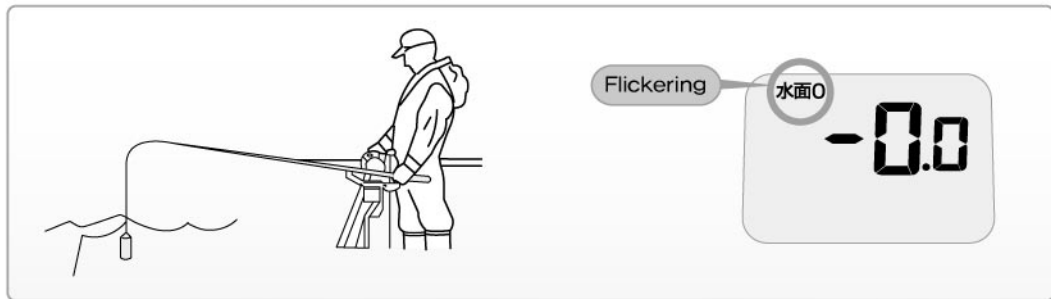

Operation methods

Operation sequence ② : Push the sides of boat stop switch. That point is "0"'s position.

"the surface of water 0" is flickering and lighting and finally lighting "OK" (Picture 21)

* "The surface of water 0", "OK" will automatically disappeared when main counter is over 10.0.



Attention

❶ "The surface of water 0" function is different from "the sides of boat stop point,"

Operation methods

3 Shelf mode

- Remember fish's swimming depth of water and it notifies you by alarming.
- Operation sequence ① : Push button when the equipment is on the your wanted depth of water, the shelf adjustment is completed.
- * The main counter is displayed on the sub counter.(refer to picture 22)
 - * After this, it notifies you by alarming before shelf 5M.

Remember of automatic shelf

- After collecting a equipment, the occasion that set up the point that fish was caught.
- Operation sequence ① : Withdraw equipment
- * If main counter's indication proceeds less than 10.0, the surface of water flickers in sub counter. (refer to picture 23)
(Flickered depth of water is the depth of water which is suspended more than minimum 5 seconds in the bottom)
- Operation sequence ② : When the depth of water is flickering, if you push the sides of boat stop switch, it is lighten and setting up shelf.(picture 24)

Picture 23



Picture 24

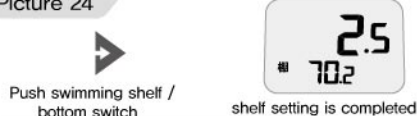

- * Occasion that emit equipment more than 10M by not pressing switch during lighting

- The depth of water which is established before it was established before displaying.
- It is deleted if do not establish the shelf.



Attention.

- It is impossible to set up self below 10M.
- It is impossible to off the shelf set during the rotation of motor.

Picture 22

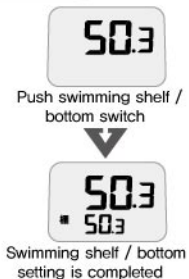

Operation methods

4 The low mode

- It displays from bottom to equipment's distance.

In the event, there is no shelf / low signal on the sub counter

Operation sequence ① : Push the side of boat stop button (refer to picture 25)

- * The shelf is displayed on the main counter.
(If the main counter is over 10M, it's set up shelf)

Operation sequence ② : Push again the sides of boat stop button over 2 seconds.

- * Low 0.0 is displayed on the sub counter.(refer to picture 26)

Picture 25



Picture 26



Push the switch
for more than
2 seconds.



In the event, shelf is displayed on the sub counter

Operation sequence ① : Push the sides of boat stop button more than 2 seconds.

- * Sub counter is changed from shelf indication to low 0.0 indication (refer to picture 27)

Picture 27



Push the switch
for more than
2 seconds.



Operation methods

The low mode methods

Operation sequence ① : Decrease the equipment to bottom and then tight the line.

* Distance is displayed on the Sub counter with tied up the line.

Operation sequence ② : Push the "swimming shelf/bottom switch" switch.

Off the shelf MODE

Operation sequence ① : Wind fishing line tightly by not releasing it after doing equipment to the bottom and serves some reel to

* Distance is displayed as wind fishing line is hanging in sub counter, (refer to picture 28)

Operation sequence ② : push the sides of boat stop button.

* It changed the (low 0.0) in the sub counter, (refer to picture 29)



* Press the switch more than 5 seconds to clear sub counter sign.

* Botton/surface and depth sigh will be cleared.

Operation methods

5 Correction of original line cut

- Correction occasion fishing line data that original line is cut by taken under shellfish etc, is possible
 - * Correction of original line cut is a tip in case original line more than 10M is cut.

Operation sequence ① : Withdraw the original line and connect equipment again.

Operation sequence ② : Push the shooting out switch more than 3 seconds(correction completion)

- * As alarm rings, main counter is displayed by 0.0 (refer to picture 30)
- * It displays OK in the sub counter.

Picture 30



Push release of fishing line/
side of boat switch more
than 3 seconds



Correction is completed

- * After correction of original line cut, please reset up the sides of boat stop point and surface of water "0".
- * If "ON/OFF" switch is pushed for more than 3 seconds at the position "0.0" of the main counter.



Attention

- ① After correction of original line cut, when do not establish the sides of boat stop point, if input equipment, side of a boat stop point becomes 5M.

Safety function

1 Check battery

- When you connect power supply, check the low pressure of battery.
- ❶ If the electric pressure is ok, the flickering battery mark is disappeared.
- ❷ In the event, the electric pressure is low, the battery marks will be lighted.
Exchange battery or recharge it (refer to picture 31)

Picture 31



- ❸ Power supply appears warning sign on screen with more high-pitched occasional alarm than reasonable extent of reel.

Picture 32



9

Safety function

2 Memory back up

- When you are doing fishing, relax even though the cord or clip is pulled out unexpectedly. The depth of water or the other data is kept and memorized for 15 minutes.



Attention

- The surface of water 0 is a different function from "the sides of boat stop point"

3 Over load control

- When overload takes to motor, brake operates and halt motor for motor protection.
- Although it is returned if use ON/OFF switch, speed is Lo-3 by automatically established. It's possible to change the speed by using the speed lever..



Attention

- The surface of water 0's point is a different function from "the neighboring stop point"
- Please don't release and recover the line at the position of power off. The counter error may occur.
- Please perform the recovery in the relieved load.

When fault is doubtful

Please confirm the below list, before asking for inquiry or repair.

Symptoms	Expected factors	Confirmation & Handling Method
"Visual display is not appeared."	<ul style="list-style-type: none"> ● In the case of connecting. ● Disconnection of power supply.. ● Battery's electric pressure is not enough. 	<ul style="list-style-type: none"> ● Connect correctly. ● Talk with the shop. ● Charge it or check another battery.
"Counter display's error is big."	<ul style="list-style-type: none"> ● Error in setting up of fishing line. ● Error in growing long fishing line. 	<ul style="list-style-type: none"> ● Input fishing line again. ● Input fishing line again.
"Automatic winding does not work."	<ul style="list-style-type: none"> ● When the display is set 0.0. ● Shortage of battery's capacity. ● When the connect cable is rusted. ● When the ship's power supply is used, (wiring problem or dropping electric pressure) 	<ul style="list-style-type: none"> ● Please display the surface of water over the sides of boat distance. ● Charge it or use another battery. ● After removing the rust, please check it. ● Exchange an exclusive battery and please check it..

if you find the abnormal symptom after you check the above list, please prepare the details about the defectives and ask the repair to the shop where you've bought the reel.

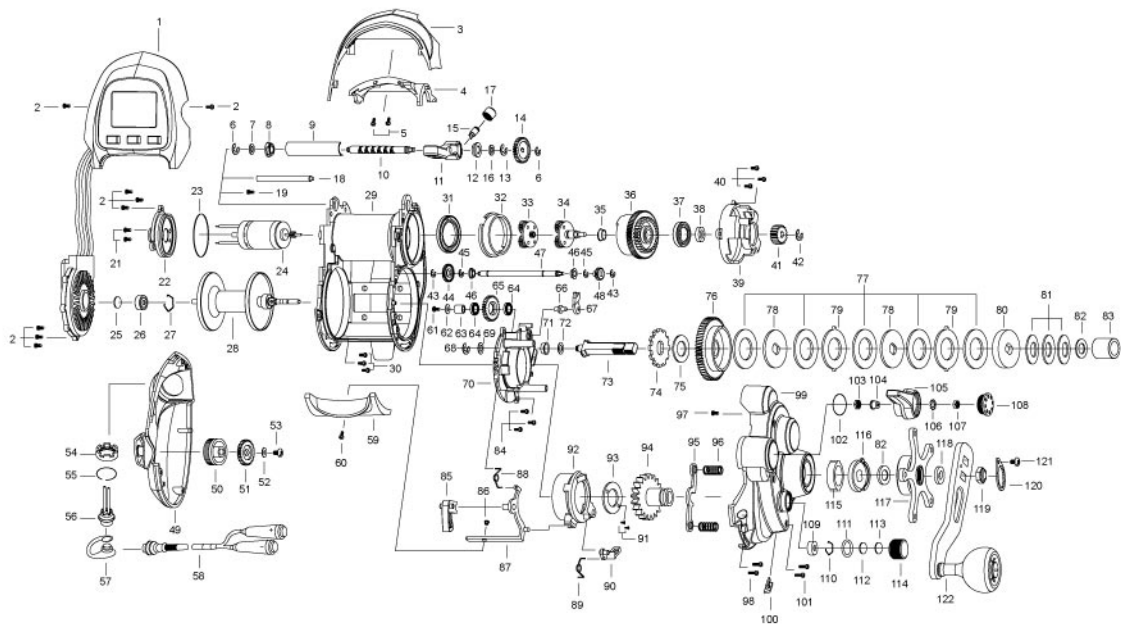

Part list

Key No.	Parts Name	Key No.	Parts Name	Key No.	Parts Name	Key No.	Parts Name
1	CONTROL BOX ASSEMBLY	33	SUN GEAR ASSEMBLY	64	BALL BEARING	95	CLUTCH BAR
2	SCREW	34	GEAR SHAFT ASSEMBLY	65	JOINT GEAR	96	COIL SPRING
3	FRONT COVER-A	35	BEARING	66	CLAW PIN	97	TAP SCREW
4	FRONT COVER-B	36	INTERNAL GEAR	67	STOPPER ASSEMBLY	98	SCREW
5	SCREW	37	BALL BEARING	68	RETAINER	99	R/COVER ASSEMBLY
6	RETAINER	38	GEAR COLLAR	69	WASHER	100	LINE STOPPER
7	WASHER	39	GEAR HOLDER	70	FRAME COVER	101	SCREW
8	BUSH	40	SCREW	71	BEARING	102	O-RING
9	PIPE	41	PINION	72	WASHER	103	NUT
10	WORM SHAFT	42	RETAINER	73	GEAR METAL	104	METAL
11	LEVEL WIND ASSEMBLY	43	RETAINER	74	RATCHET	105	SPEED LEVER
12	BUSH	44	JOINT GEAR-B	75	WASHER	106	TOOTH WASHER
13	RETAINER	45	RETAINER	76	DRIVE GEAR	107	NUT
14	TRAVERSE GEAR	46	COLLAR	77	WASHER	108	LEVER CAP
15	LEVEL WIND PIN	47	JOINT SHAFT	78	WASHER-D1	109	BEARING
16	WASHER	48	JOINT GEAR-A	79	WASHER-A	110	RETAINER
17	NUT	49	LEFT SIDE PLATE	80	WASHER-D2	111	O-RING
18	PILLAR	50	SPEED DIAL	81	DRAG SPRING	112	WASHER
19	SCREW	51	DIAL GEAR	82	WASHER	113	WASHER
21	SCREW	52	WASHER	83	BUSH	114	TENSION KNOB
22	MOTOR COVER ASSEMBLY	53	TAP SCREW	84	SCREW	115	COLLAR
23	O-RING	54	NUT	85	RETURN LEVER	116	CLICK HOLDER ASSEMBLY
24	MOTOR ASSEMBLY	55	SPRING WASHER	86	T-NUT	117	STAR DRAG ASSEMBLY
25	WASHER	56	CONNECTOR ASSEMBLY	87	C/LEVER CAM ASSEMBLY	118	WASHER
26	BALL BEARING	57	WATER CAP	88	CAM SPRING	119	HANDLE NUT
27	RETAINER	58	전원 CODE ASSEMBLY	89	KICK LEVER SPRING	120	RETAINER
28	SPOOL ASSEMBLY	59	CLUTCH LEVER	90	KICK LEVER	121	SCREW
29	FRAME ASSEMBLY	60	SCREW	91	SCREW	122	HANDLE ARM ASSEMBLY
30	TAP SCREW	61	SCREW	92	CLUTCH CAM		
31	BALL BEARING	62	WASHER	93	PLATE		
32	BEARING COLLAR	63	METAL COLLAR	94	SPOOL GEAR		

banax